



 **MONTIGO**<sup>®</sup>  
the art of fireplaces  
[www.montigo.com](http://www.montigo.com)

**L-Series See-Thru**

# L-Series See-Thru

Direct Vent · Flush Face  
Multi Sided Fireplace



## Features:

- ❑ Clean-Face design allows for brick or tile installation over the fireplace frame
- ❑ Convertible using 5"/8" Top or Side vent on L38DF-ST & L42DF-ST
- ❑ L52DF-ST is 5"/8" Top Vent only
- ❑ Linear Contemporary burner with White, Silver, Opaque Fire Stones†
- ❑ Snap-Lock door system
- ❑ Hi/Lo control for adjusting flame level
- ❑ Millivolt control with Piezo spark ignition allows for continuous operation, even during a power failure
- ❑ 100% fail-safe shut-off valve

## Options:

- ❑ Various Linear Contemporary burner accessories†
- ❑ Choose from 2 surrounds†
- ❑ Digital Thermostat
- ❑ Various Remote Control options
- ❑ Safety door screen
- ❑ Various Fan Kits for L38DF-ST & L42DF-ST
- ❑ IPI Electronic Ignition with optional remote control for flame modulation, thermostatic control, & battery backup
- ❑ Full stainless steel construction, approved for outdoor use

† Go to [www.montigo.com](http://www.montigo.com) for colour images

Fireplace BTU/H Input		
Model#	Natural Gas	Liquid Propane
L38DF-ST	27,000	27,000
L42DF-ST	34,000	34,000
L52DF-ST	40,000	40,000

Consult the owner's manual for complete installation instructions and proper clearances to combustible surfaces prior to installing fireplace.

All specifications, framing dimensions, product designs, materials and colors are subject to change without notice. The actual flame pattern and color may vary slightly from the illustrations. Diagrams and illustrations are not to scale.

Options & accessories may have associated surcharge.

Unit Dimensions											
	A	B	C	D	E	F	G	H	I	J	K
L38DF-ST	37¾"	29½"	18"	35¼"	6¼"	5¼"	33¾"	24"	5"	8"	26¾"
L42DF-ST	42"	30½"	19"	39½"	6¼"	5¼"	34¾"	24"	5"	8"	27¾"

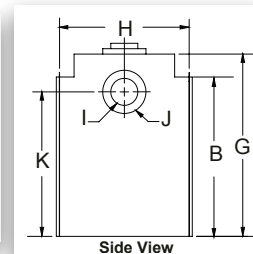
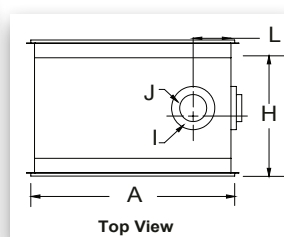
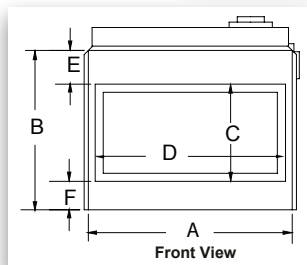

Unit Dimensions										
	A	B	C	D	E	F	G	H	I	J
L52DF-ST	52"	33¾"	21¾"	47"	6¾"	5¼"	23¾"	58"	5"	8"

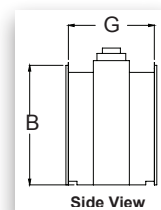
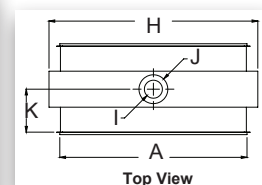
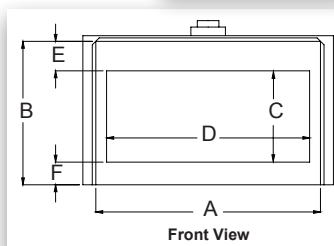

Framing Dimensions				
	M	N	O	P
L38DF-ST	40"	41"	23¾"	34½"
L42DF-ST	40"	45"	23¾"	36"
L52DF-ST	39"	60"	23¾"	N/A

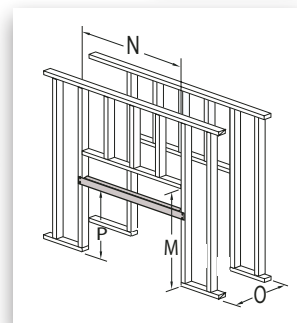

**Warranty:** The manufacturer warrants this fireplace to be free from defects in materials and workmanship at the time of manufacture. There is a limited 10 year warranty on the firebox; 5 year limited warranty on the burner and 1 year limited warranty on the pilot burner assembly and fan motors (if included). The valve carries a limited 1 year warranty unless otherwise specified in the installation manual. Glass, plated/painted finishes and refractory lining are exempt.



**MONTIGO**  
the art of fireplaces

[www.montigo.com](http://www.montigo.com)

Ferndale, Washington  
TF 1.800.789.6236  
FX 1.866.300.0927

Langley, British Columbia  
TF 1.800.378.3115  
FX 1.604.607.6462

Available at:

Printed in Canada

P/N XB2102

091511