

Installation & Maintenance Manual

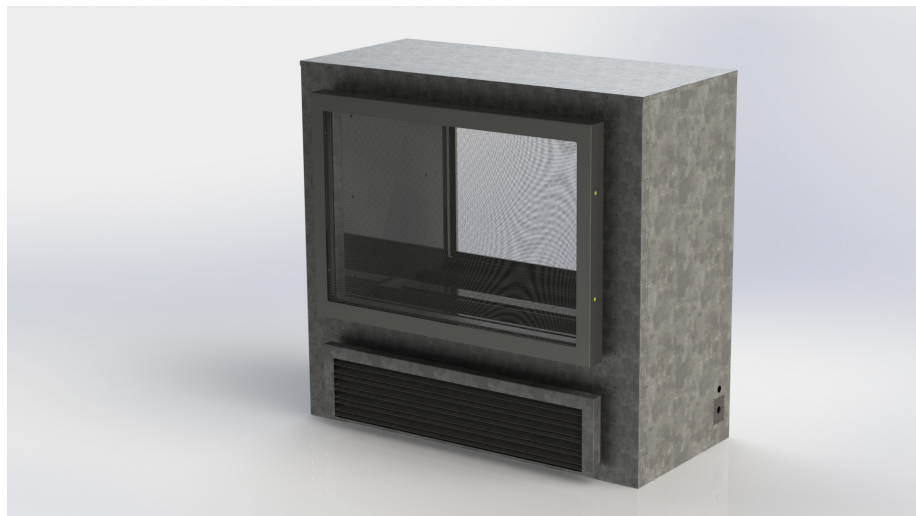

R324-ST
Indoor/ Outdoor
Ventless USA

See Through
Residential
Fireplace



DANGER

Read and understand this manual. Improper installation, adjustment, alteration, service or maintenance can cause serious injury, property damage or even death. For assistance or additional information consult a qualified installer, service agency or the gas supplier.



WARNING

Do not store or use gasoline or any other flammable vapors and liquids in the vicinity of this or any other gas burning appliance. A fire or explosion may occur causing serious injury, property damage or even death.

NOTICE

Installer: Leave this manual with the appliance. Do not remove.

Consumer: Retain this manual for maintenance and future reference. Do not Discard.

WARNING

CARBON MONOXIDE HAZARD

This appliance can produce carbon monoxide which has no odor. Using it in an enclosed space can kill you. Never use this appliance in an enclosed space such as a camper, tent, car or home.



DANGER



**HOT GLASS WILL
CAUSE BURNS.**
**DO NOT TOUCH GLASS
UNTIL COOLED.**
**NEVER ALLOW CHILDREN
TO TOUCH GLASS.**

A barrier designed to reduce the risk of burns from the hot viewing glass is provided with this appliance and shall be installed for the protection of children and other at-risk individuals.

DANGER

IF YOU SMELL GAS

- ⚠ Do not try to light any appliance.
- ⚠ Do not touch any electrical switch; do not use any phone in your building.
- ⚠ Immediately call your gas supplier from a neighbor's phone. Follow the gas supplier's instructions.
- ⚠ If you cannot reach your gas supplier, call the fire department.



NOTICE

You must read and understand this manual prior to installation, operation or troubleshooting this appliance. Please retain this owner's manual for future reference and maintenance.

Table of Contents

Instruction Manual Contents

Safety Alerts	3
Introduction	3
Before You Start	4
Rating Plate Sample	5
Section 1: Installation Overview and Product Dimensions	6
Section 2: Framing	7
Section 3: Finishing	8
Section 4: Installing the Gas Line	11
Section 5: Electrical Connection	11
Section 6-a: Removing & Installing the Interior Screen and Door	12
Removing the Screen and Door	12
Section 6-b: Removing & Installing the Outside Screen and Door	13
Section 7: Installing the Firestones	14
Firestones	14
Optional Crushed Glass	14
Optional River Rocks	14
Optional Ceramic Speckled Stones	14
Optional Driftwood Logs	15
Section 8: Start-up Sequence	18
Section 9: Cleaning and Maintenance	19
General	19
Cleaning	19
Section 10: Wiring	20
Section 11: Accessing the Control Panel	21
Replacement Parts	22
Appendix A: Warranty	23
Appendix B: State of Massachusetts	24
Appendix C: Canadian Installation Notice	25

Safety Alert Key

Safety Alerts



DANGER

Indicates a hazardous situation which, if not avoided, **WILL** result in death or serious injury or property damage.



WARNING

Indicates a hazardous situation which, if not avoided, **COULD** result in death or serious injury or property damage.



CAUTION

Indicates a hazardous situation which, if not avoided, **WILL** result in minor or moderate injury.

NOTICE

Addresses practices that are important, but not related to personal injury

Introduction

Introduction

Congratulations on your purchase of a Montigo Fireplace.

With over 30 years of experience, Montigo is committed to providing you with a gas fireplace that is not only a beautiful addition to your space, but that is also designed and manufactured to the highest safety, reliability and engineering standards.

We strongly encourage you to read and carefully follow the instructions laid out in this Installation, Operation and Maintenance Manual and retain it for your future reference. Pay special attention to all cautions, warnings, and notices throughout this manual intended to ensure your safety.

This manual covers installation, operation and maintenance. Lighting, operation and care of this fireplace can be easily performed by the homeowner. All installation and service work should be performed by a qualified or licensed installer, plumber or gas fitter as certified by the state, province, region or governing body where the fireplace is being installed.

This installation, operation and maintenance manual is applicable to the models described below. Refer to your rating plate to verify included options. ***Warranty and Installation Information: (See Appendix A)***

The Montigo warranty will be voided by, and Montigo disclaims any responsibility for, the following actions:

- Modification of the fireplace and/or components including Direct-Vent assembly or glass doors.
- Use of any component part not manufactured or approved by Montigo in combination with this Montigo fireplace system.
- Installation other than as instructed in this manual.

Consult your local Gas Inspection Branch on installation requirements for factory-built gas fireplaces. Installation & repairs should be done by a qualified contractor.



CAUTION

Young children should be carefully supervised when they are in the same room as the appliance. Toddlers, young children and others may be susceptible to accidental contact burns. A physical barrier is recommended if there are at risk individuals in the house. To restrict access to a fireplace or stove, install an adjustable safety gate to keep toddlers, young children and other at risk individuals out of the room and away from hot surfaces.



Installation

Before You Start

Important Message

Save these Instructions

The C-View Residential R324-STIO Ventless fireplaces must be installed in accordance with these Instructions. Carefully read all the Instructions in this manual first. Consult the Local Gas Branch to determine the need for a permit prior to starting the installation. It is the responsibility of the installer to ensure this fireplace is installed in compliance with the manufacturers instructions and all applicable codes.

BEFORE YOU START:

NOTICE

Installation and repairs should be done by an authorized gas fireplace service technician. The appliance should be inspected before use and at least annually by a professional. More frequent cleaning may be required due to excessive lint from carpeting, bedding material, etc. It is imperative that control compartments, burners and circulating air passageways of the fireplace are kept clean.



CAUTION

Due to high operating temperatures, this appliance should be located out of traffic & away from furniture and draperies.

Children and adults should be alerted to the hazards of the high surface temperature, which could cause burns or clothing ignition.

Young children should be carefully supervised when they are in the same room as the appliance.

Clothing or other flammable materials should not be placed on or near the appliance.



DANGER

When this appliance is installed directly on any combustible material other than wood flooring, it must be installed on a metal or wood panel extending the full width and depth of the appliance or a fire will occur causing serious injury, property damage or even death.

WARNING

A barrier designed to reduce the risk of burns from hot viewing glass is provided with this appliance and shall be installed for the protection of children and other at-risk individuals.

If the barrier becomes damaged, the barrier shall be replaced with the manufacturer's barrier for this appliance.

WARNING

Any safety screen, guard, or barrier removed for servicing an appliance must be replaced prior to operating the appliance.

Pre-Installation Checklist

- Determine the desired install location of your fireplace.
- See Section 1, Dimensions on Page 5, and refer to the Framing Section 2 for details.
- The electrical panel is located on the lower right side when facing the interior side of the fireplace.
- Montigo supplies 20' of low voltage wire, which can be spliced to any length. This wire CANNOT run in conduit with any other wire.
- Refer to Section 5, Wiring for Details.
- The gas connection is located on the lower left when facing the interior side of the fireplace.
- Refer to local codes and guidelines for installation requirements.
- Locate unit rating plate under media tray on indoor side.
- Installation and repairs should be done by a qualified contractor and must conform to:
 - Installations in Canada must conform to the current CAN/CGA B-149.1 and .2 Gas Installation Code and local regulations.
 - Installations in the USA must conform to local codes, or in the absence of local codes to the National Fuel Gas Code, ANSI Z223.1
 - Unit must be raised 10" from the grade.
 - See Appendix B for installation within the State of Massachusetts. This fireplace must comply with NFPA-54 Chapter 10.
 - Unit must be raised 10" from the grade.
- Refer to Section 4, "Installing the Gas Line" for Details.

Understanding the Basic Operation

Residential R324-STIO fireplace

The control compartment of this fireplace is located in the bottom of the fireplace right below the burner system. Accessible from the indoor side, all models will be supplied with a Honeywell smart valve gas control and will not have a variable flame control. There is one air switch that is controlling the gas control system, and is located in the bottom of this fireplace. These gas valves, and pressure switches communicate with the electrical control panel.

To operate the fireplace, Montigo has supplied and installed twenty feet of low voltage wire to this electrical control panel. Connect the two wire harness to a standard single pole ON/Off switch located at a location of your choice. You may also extend these wires up to 100', as long as you select a wire of equal quality. DO NOT CONNECT ANY POWER TO THIS WIRE.

Unit MUST be installed on an exterior wall. It cannot be installed fully indoors or fully outdoors.

Installation



Rating Plate Sample

**Do Not Remove
This Label
N'enlevez Pas
Cette Étiquette**

Type: Outdoor Decorative Gas Fireplace/Vented Gas Fireplace

Not for use with solid fuel: / Pas pour l'usage avec le combustible solide.

Not for use with air filters: / Pas pour l'usage avec des filtres à air.

R324-ST-IO-I

Model No. Modèle: 2-150316-0000000000

Serial No.: Canadian Heating Products Inc., Langley BC, www.montigo.com
Montigo DelRay Corp., Ferndale, WA, www.montigo.com

Tested To / Examiné À: ANSI Z21.97/ CSA 2.41-2014 and ANSI Z21.50/ CSA 2.22-2014

Electrical Rating / Estimation Électrique: 115V / 1Ph / 60Hz / less than 12A

Altitude Rating / Estimation D'Altitude: N & H (0 - 4500 ft. / 0 - 1371 m).

Fuel Type / Type De Carburant:

☒ **N - Natural Gas / Gaz Naturel**
☐ **LP - Propane / Gaz Propane**

Max. Input Max. Entrée BTU/H	Min. Input Min. Entrée BTU/H	Output / Rendement BTU/H	Orifice Size / Taille D'Orifice Front/Avant Rear/Derrière
50,000	50,000	N/A	3@45 DMS / N/A
N/A	50,000	50,000	3@ 1.25mm / N/A

***Clearance to Combustibles
Dépassements Aux Combustibles ***

Sides/Côtés: 1/2"

Back/Derrière: NC

Top-Top Vent/Du Haut-Évent Du Haut: 3"

Top-Rear Vent/Du Haut-Évent Arrière: 3"

Floor/Plancher: NC

Mantel/Manteau: NC

Recess Depth/ Profondeur D'Encadrement: N/C

Flue: N/A

Gas Manifold Pressure / Pression D'Admission Du Gaz	Min. Gas Supply Pressure/ Min. Pression D'Alimentation Du Gaz
3.5" W.C.	5.5" W.C.
10" W.C.	11" W.C.

FOR USE WITH GLASS DOORS AND SCREENS CERTIFIED WITH THE APPLIANCE ONLY

Pour utilisation avec portes de verre et écrans de certifiés avec l'appareil seulement

***Refer to installation manual for more information.**

*Référez-vous au manuel d'installation pour plus d'information.

LB1-1207D-V5.0 R(P)VIEW_HSI_WITH_SCREEN_DEC.11.2014

Figure A: Rating Plate for R324-ST



Installation

Section 1: Installation Overview and Product Dimensions

Please review the Pre-Installation Checklist on Page 4 for general information on preparing for a successful installation of your fireplace.

The C-View Residential R324STIO fireplace

The C-View Residential R324STIO fireplaces may be installed in any location that maintains proper clearances to air conditioning ducts, electrical wiring and plumbing. Safety, as well as efficiency of operation, must be considered when selecting the fireplace location. Try to select a location that does not interfere with room traffic, has adequate ventilation, and offers an accessible pathway for Power Vent installation.

The fireplace dimensions are shown below:

R324STION	50,000 BTU/HR	NG
R324STIOL	50,000 BTU/HR	Propane

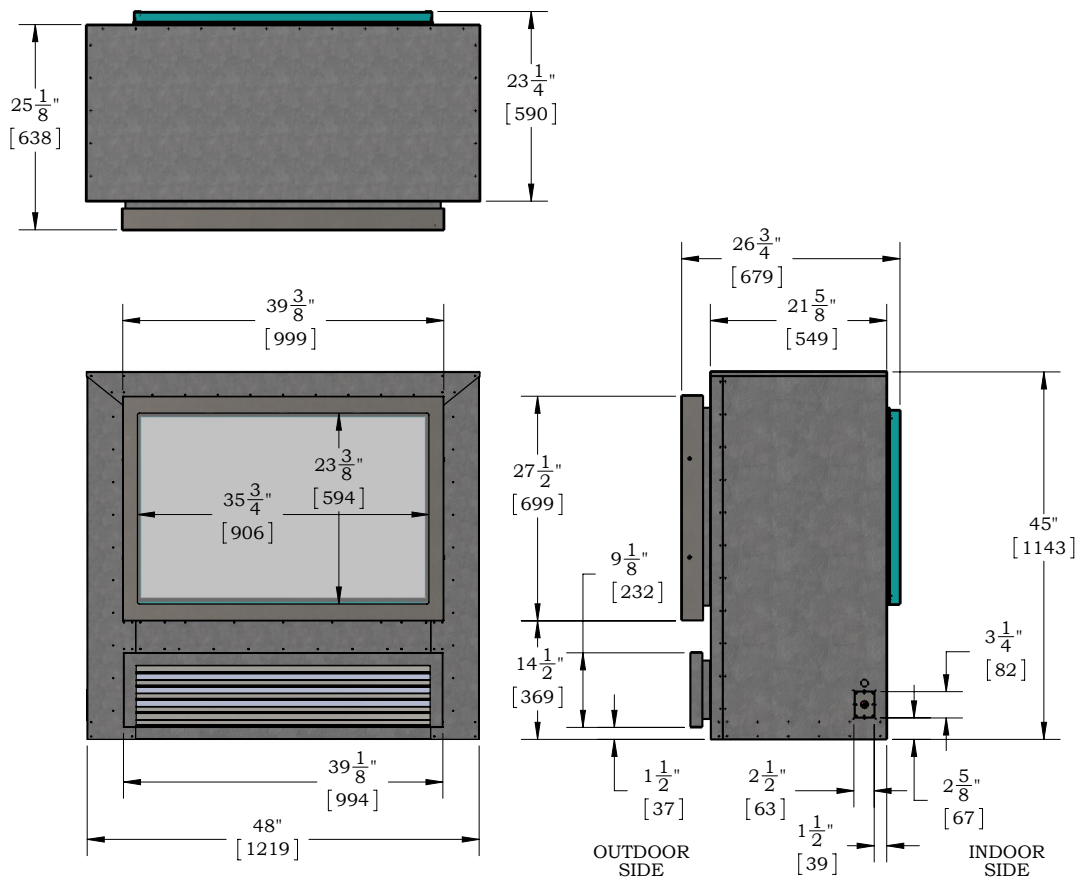

Figure 1: Unit Dimensions

Note: Images are shown without screens for clarity purposes. However, your fireplace should not be operated without proper installation of screens.

Installation



Section 2: Framing

Step 1. Frame the opening in the location that you have selected for your fireplace. The dimensions of the opening should be X" wide by Y" high. (see Table)

	X	Y
Combustible Framing	49"	48"

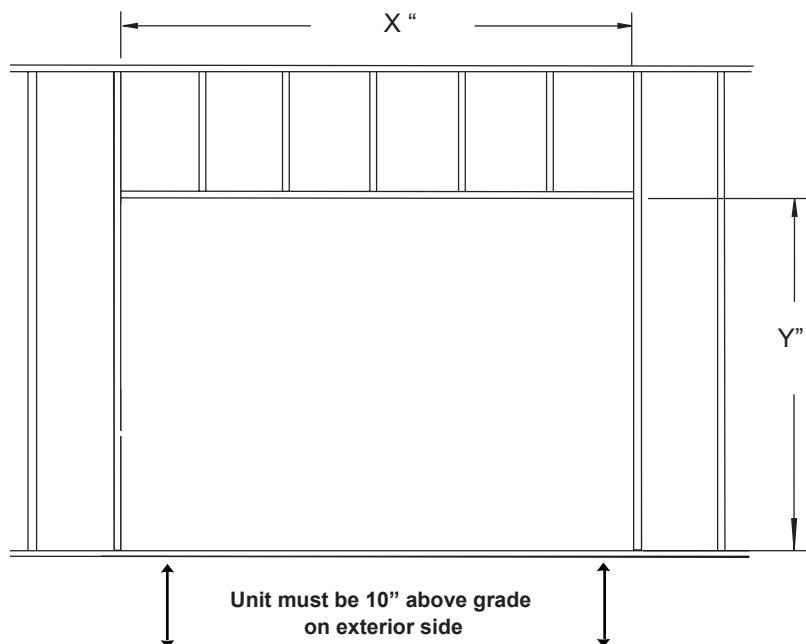
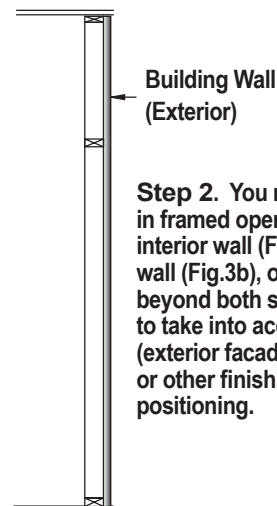

Figure 2: Framing Dimensions



Step 2. You may position the unit in framed opening to be flush to the interior wall (Fig. 3a) flush to the exterior wall (Fig.3b), or partially extending beyond both sides (Fig. 3c). Be sure to take into account finished surfaces (exterior facade and interior drywall or other finish when determining final positioning.

Clearances:

MODEL	Sides	Floor Indoor	Floor Outdoor	Top
R324-STIO	1/2"	0"	10"	3"

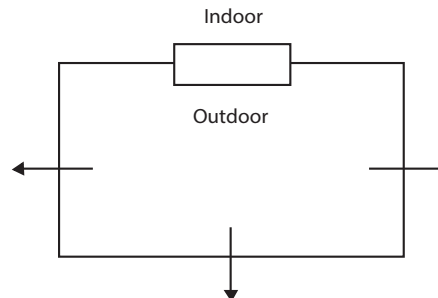

Note: For all positions, outside face must be positioned on OPEN non-obstructed patio.

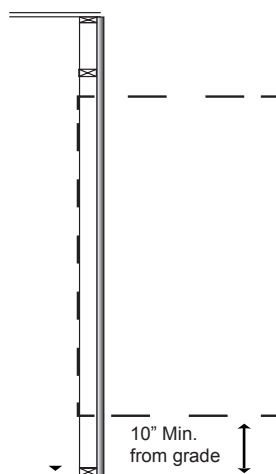

Figure 3a: Unit flush to interior wall

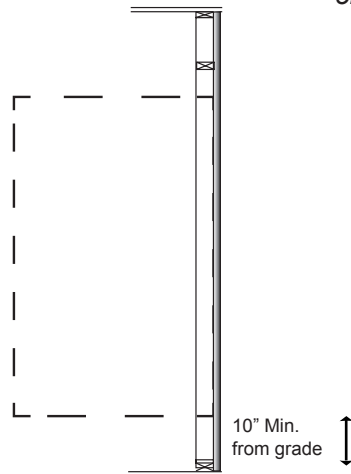

Figure 3b: Unit flush to exterior wall

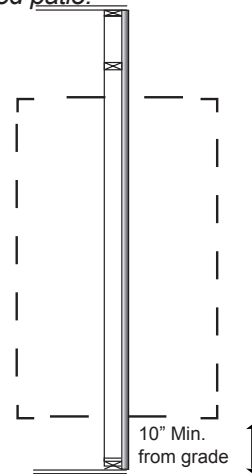

Figure 3c: Unit extends beyond both interior and exterior wall



Installation

Section 3: Finishing

FINISHING THE UNIT ON THE EXTERIOR OF THE BUILDING:

STEP 1: Select a location such that the fireplace floor maintains a 10" clearance above grade (see Fig. 4d). The power vent module will expel high temperature flue gases through the louvers. When selecting the material for the hearth please keep in mind the potential for discoloration due to high temperatures.

STEP 2: Determine where the unit will be placed in relation to the exterior wall. Position flashing such that it will be flush to the exterior wall when installed.

STEP 3: Attach the flashing provided to the fireplace exterior using the sheet metal screws provided. (see Fig.4) Apply a bead of silicone to the back of the flashing to ensure a proper seal.

(Please note: You may drill a 1/8" starter hole into the outside skin of the fireplace using the cobalt drill bit provided in your flashing kit.)

STEP 4: Slide the unit in place into the intended location from the outside of the building until the flashing is flush with the building exterior. (See Fig. 4a)

Nail the flashing to the exterior sheathing of the building

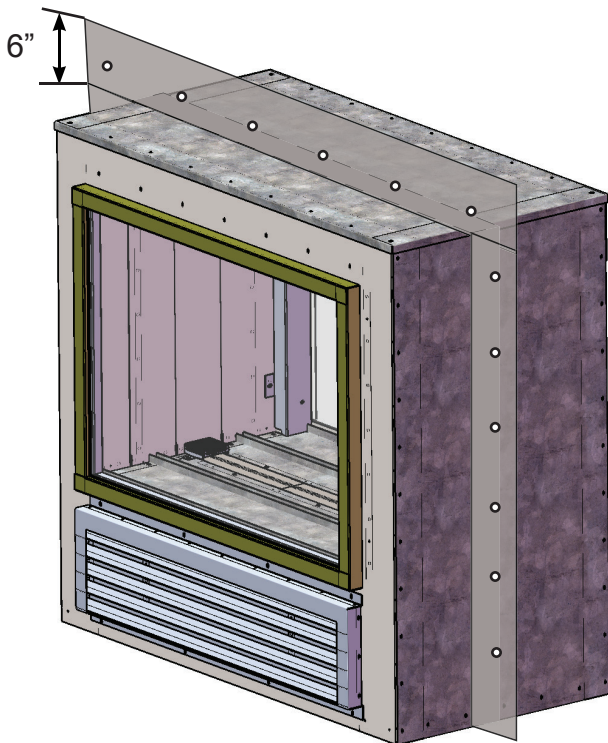

Figure 4: Attach flashing to unit using sheet metal screws provided, apply a bead of silicone to flashing where it meets the unit

STEP 5: Cover the flashing with approved waterproofing membrane brought to the 1/2" edge of the unit (See Fig. 4b).

STEP 6: Install steel stud construction (or other non-combustible) to create 1/2" clearance on sides and 3" clearance on top before installing finishing materials. (See. 4c)

(Please note: Ensure that all materials installed on the face of the unit provide adequate clearance to allow the removal of door and louvers as required.)

MAINTAIN CLEARANCE of 1/2" on sides and 3" on top TO ALL COMBUSTIBLE MATERIALS FROM THE UNIT ON SIDES, TOP AND FACE OF THE UNIT

STEP 7: Cover face, framed sides and framed top with material of your choosing.

ENSURE THERE IS NO OBSTRUCTION IN FRONT OF THE LOUVERS AT ANYTIME AS THIS MAY RESULT IN THE POWER VENT MOTOR OVERHEATING.

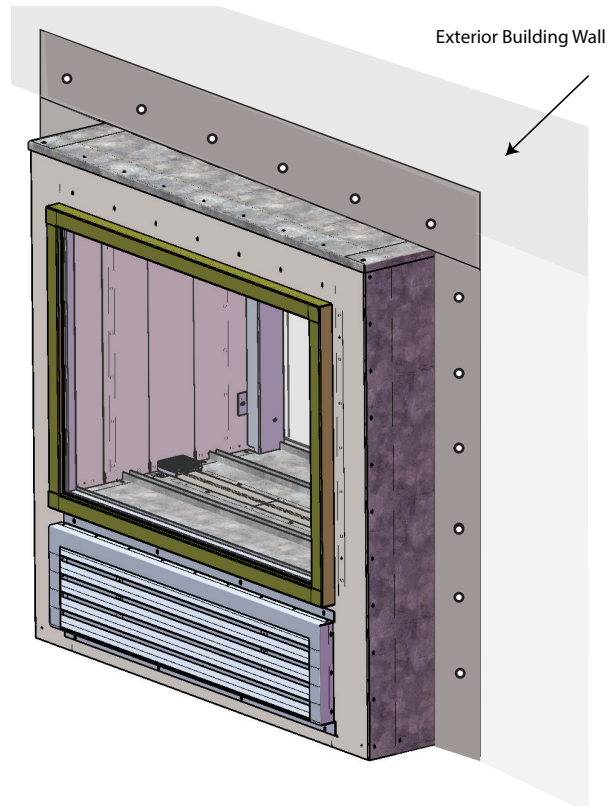

Figure 4a: Slide unit into place from the outside of the building until the flashing is flush to the exterior wall

Installation



Section 3: Finishing

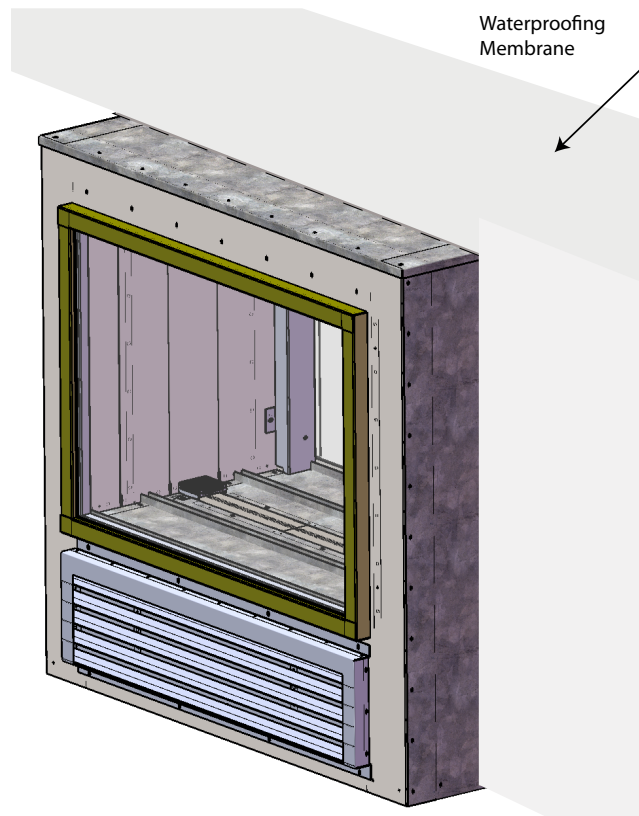

Figure 4b: Cover the flashing with the approved waterproofing membrane for the building

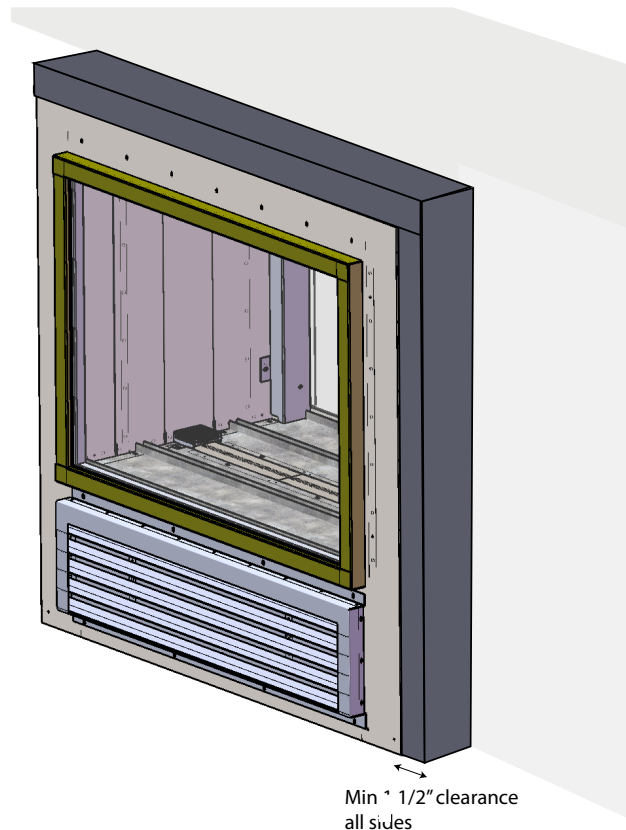

Figure 4c: Install Steel studs for 1/2" clearance on sides and top

NOTE: Please refer to Appendix C for information specific to Canadian installations.

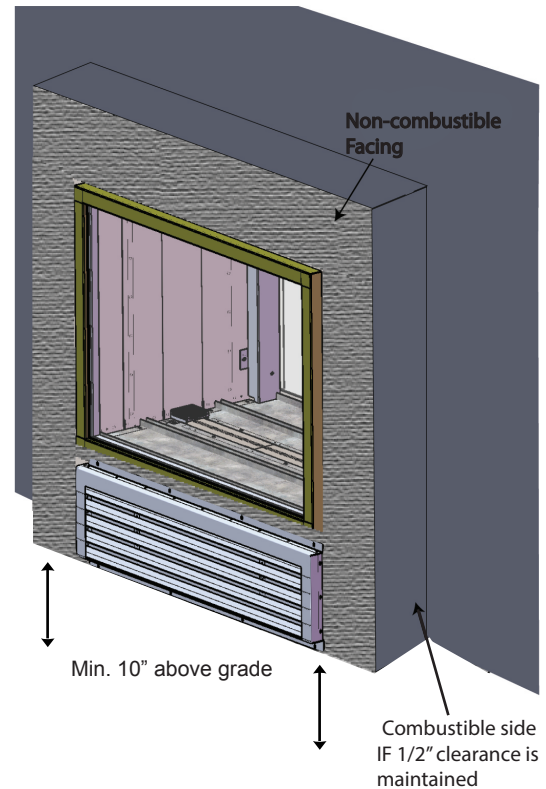

Figure 4d: Clearance above grade

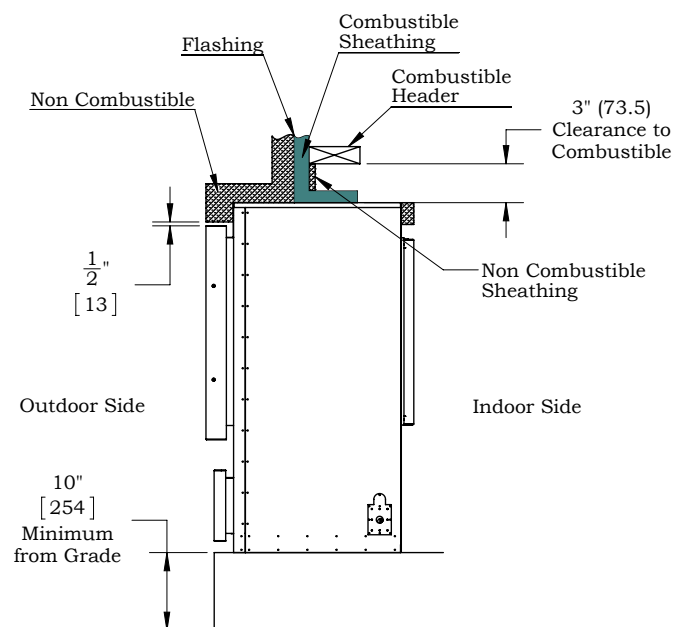

Figure 4e: Non-combustible limits



Installation

Section 3: Finishing

FINISHING THE UNIT ON THE INTERIOR OF THE BUILDING:

STEP 1: Once the unit is in place from the outside, confirm that there is clearance to combustibles; 1/2" on the sides and 3" on the top. (See Fig. 4a)

STEP 2: Fill the gap to sides and top with insulation that is rated for minimum 250 degrees Fahrenheit.

STEP 3: Install non-combustible facing material such as cement board or tile on the front inside face of the unit. (See Fig 4b)

STEP 4: Install drywall or other finishing material.

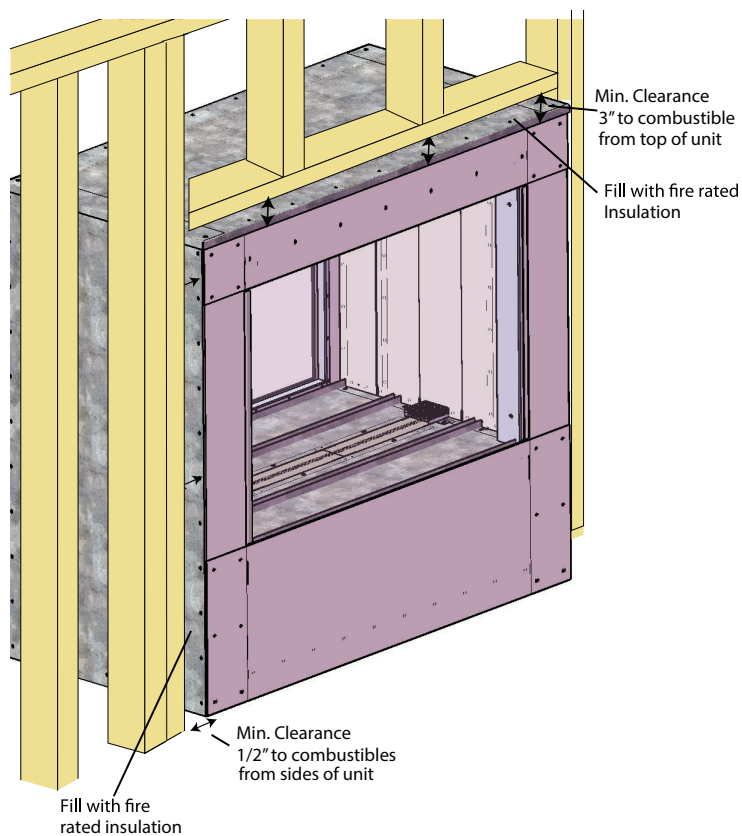

Figure 5 Interior framing

Note: Images are shown without screens for clarity purposes. However, your fireplace should not be operated without proper installation of screens.

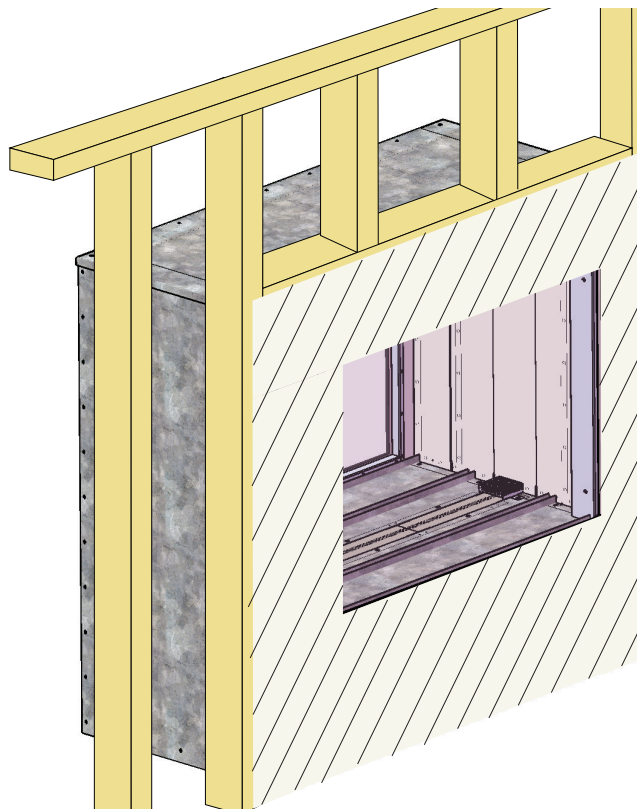

Figure 5a: Interior face of unit - non-combustible

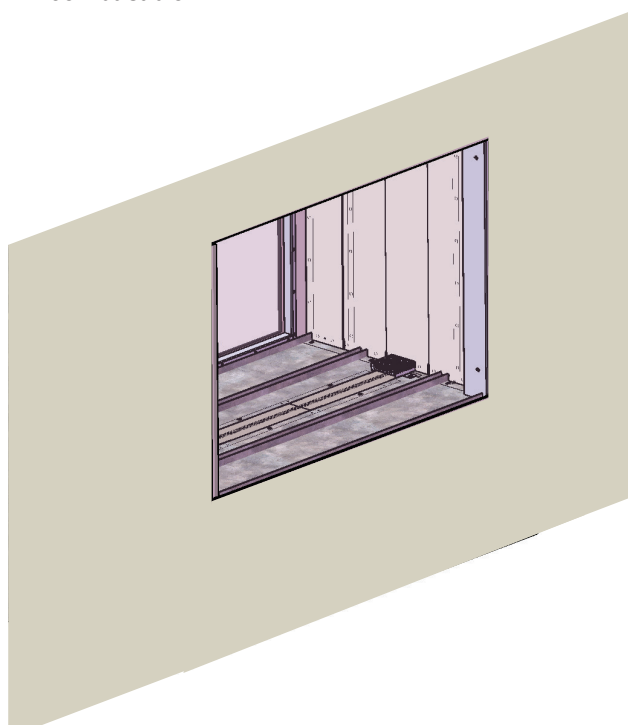

Figure 5b: Finished interior installation

Installation



Section 4: Installing the Gas Line

Fuel Consumption

Verify that your fireplace is compatible with your available gas type. (Natural Gas or Propane shown by "N" or "L" in your model number)

If gas type is not compatible, contact your local Montigo representative to purchase a conversion kit.

Conversion kits must be installed by a qualified service technician.

Gas Pressure

Optimum appliance performance requires proper input pressures.

Gas line sizing requirements will be determined in ANSI 223.1 National Fuel Gas Code in the USA and CAN/CGA B149 in Canada.

Pressure requirements:

Pressure Requirements		
Gas Pressure	Natural Gas	Propane
Minimum Inlet Pressure	5.5" W.C.	11" W.C.
Manifold Pressure	3.5" W.C.	10" W.C.

The manifold outlet pressure is set from the factory to the appropriate pressure but should be verified.

To check pressures, control valves have a provision to remove a 1/8" N.P.T. plug to be fitted with a hose barb.

Montigo requires a service shut off valve be located in an accessible location to isolate the gas supply.

Only install gas shut-off valves approved for use by the state, province, or other governing body in which the fireplace is being installed.

GAS CONNECTION

The gas connection is located on the left side of the fireplace looking at the indoor face of the unit.

Connect this line to a service shut of valve as per local code.

Make sure that the gas line as well as the shut of valve will be rated for 75,000 BTU

Purge all air out of the gas line prior to start up.

Flexible gas connectors must not exceed 3 feet in length, unless allowable within local regulations.

Connect incoming gas line to the 1/2" or 3/8" gas inlet port.

Check appliance connection, valve and valve train under normal operating pressure with a commercially available leak check solution.

DO NOT USE A FLAME OF ANY KIND TO TEST FOR LEAKS.



DANGER

After gas line is connected, each appliance connection, valve and valve train MUST be checked while under normal operating pressure with either a Liquid Solution, or Leak Detection Device, to locate any source of leak. Tighten any areas where bubbling appears or a leak is detected until bubbling stops completely or leak is no longer detected. DO NOT use a flame of any kind to test for leaks. A fire or explosion will occur, causing serious injury, property damage or death.

NOTICE

When pressure testing the fireplace, Gas line, and input system follow the appropriate local codes or your area. DO NOT connect the fireplace to pressures in excess of 1/2lb. This will damage the gas control valve.

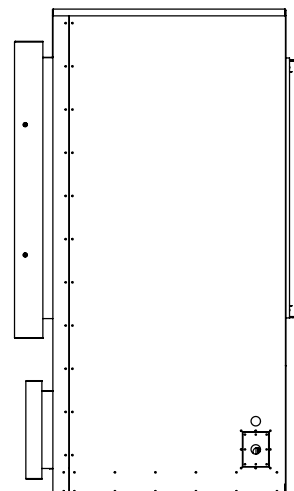

Figure 6. Gas Inlet Supply location, (left-hand side of fireplace facing indoor face).

Section 5: Electrical Connection

- Connect 115 Volt 12 Amp power supply to the connection box located on the right side bottom corner of this fireplace.
- There is 25 Feet of low voltage wire coiled up on the same side of this fireplace.
- Run this low voltage wire to an on / off switch at a location of your choice.
- If this wire is inadequate in length you may replace this wire with any Number 18 gage solid or stranded wire in any length.
- Do not splice these wires. Run a new wire directly from the control board to the switch location.
- Caution: Do not apply any power to these two wires.

CAUTION

We recommend careful consideration be given to the effects of elevated mantel temperatures which may be in excess of product design, for example: candles, plastic or pictures. This can cause melting, deformation, discoloration or premature failure of T.V. radio, and other electronic components.

CAUTION

When covering the upper metal portion of the fireplace, (as shown, Fig.16) with a non-combustible material, Please Note: The decorative facing materials may be subject to temperatures in excess of 250° F. This should be considered when selecting facing materials.



Installation

Section 6-a: Removing & Installing the Interior Screen and Door

Removing the Screen and Door:

Step 1. Remove the screen by pulling firmly with your fingers, and remove from the bottom then the top. (See Figure 7).



Figure 7. Removing the screen

Step 2. Remove the supplied glass lifting tool from the packaging. Place in the center of the Glass door as shown, and activate the suction feature of the tool, Figure 7a. NOTE: Read ALL the instruction supplied with the tool, and follow the associated operating procedures.



Figure 7a. Supplied Glass lifting tools.

Step 3. Hold the Glass Removal Tools firmly, Lift the door upward, into the top door frame, Figure 7b. Then pull the bottom of the glass door downward, and tilt outward from the bottom fireplace door frame. Figure 7c. NOTE: Read ALL the instructions supplied with the tool, and follow the associated operating procedures.



Figure 7b. (Lift the door upward)

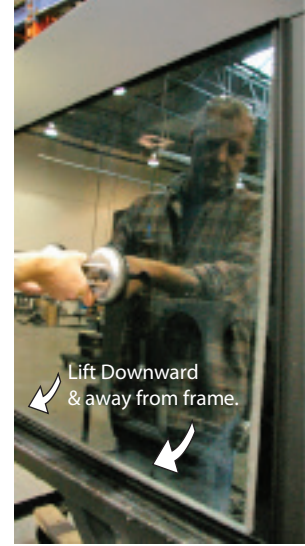

Figure 7c. (Lift the bottom of the door outward).

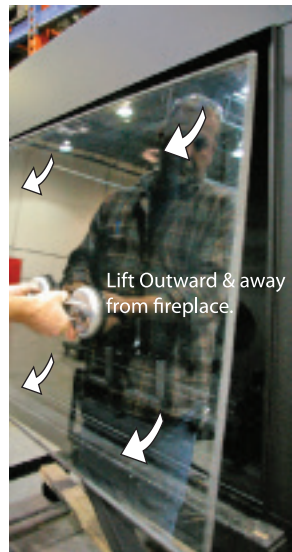

Figure 7d.

Step 4. Still holding the Glass Removal Tool firmly, remove the door outward, and away from the Fireplace, Figure 7d.

Step 5. Place the door in a safe location while maintenance, cleaning or other operation are in progress.

NOTE: Read ALL the instructions supplied with the tool, and follow the associated operating procedures.

Step 6. To reinstall, reverse steps.

NOTICE

Do not use ammonia based or abrasive cleaners on the glass, they will permanently etch the surface. Use an approved gas fireplace glass cleaner such as Kel-Kem or White off.

Installation



Section 6-b: Removing & Installing the Outside Screen and Door

Step 1. Lift the decorative screen frame up and out, and off of the fireplace (as shown below in Figure 7e).



Figure 7e. Lifting screen frame up and out.



Figure 7f. Lifting screen frame off fireplace.

Step 3. Remove the screws that secure the screen to the unit. Make sure to hold the screen securely as you remove the last few screws to prevent the screen from falling.



Figure 7g. Removing screws that secure screen.

Step 3. To remove the outer door, remove screws that secure the door to the fireplace. Make sure to hold onto the door securely as you remove the last few screws.

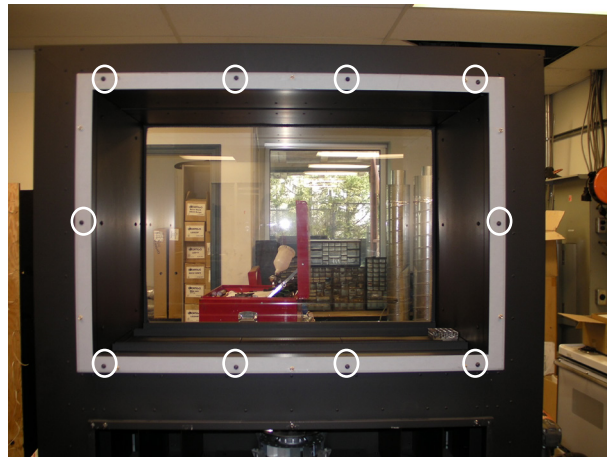

Figure 7h. Removing screws that secure door.

Step 4. To reinstall, reverse steps.

NOTICE

Do not use ammonia based or abrasive cleaners on the glass, they will permanently etch the surface. Use an approved gas fireplace glass cleaner such as Kel-Kem or White off.

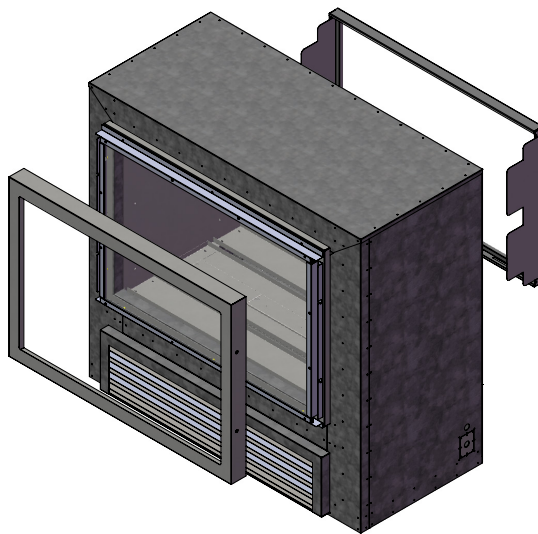

Figure 7i Screen removal (3D rendering)



Installation

Section 7: Installing the Firestones

The C-View Residential R324STIO fireplace has the option of installing the supplied glass Firestones, other colored glass media, or cultured rocks.

Firestones

The C-View Residential R324-STIO fireplace is supplied with Glass Firestones. To install the Firestones remove the Door and trim as shown in the previous Instruction. Follow these instructions to ensure all parts are removed or replaced as required. Once the Trim and glass doors are removed fill the three trays with the firestones supplied.

Do not overfill the trays. Firestones should not be piled higher than the tray edge

Do not pile glass media on top of the pilot cage.

Re-install doors and proceed with Section 8: start up sequence.



Figure 8. Completed glass Firestone installation.

Optional River Rocks

The C-View Residential fireplace has the option of installing the cultured rocks which mimic real stone. These may be spaced at random, or in a visual pattern of your preference without touching the flame. See the Montigo web site for photographs and ideas.

www.montigo.com

NOTICE

Do not operate this fireplace without the glass door or with a broken glass door.

Optional Ceramic Speckled Stones

The R324STIO Residential fireplace has the option of installing speckled stones. Place 175 stones in each outer tray and 250 stones in the middle tray. Place the stones at random with the numbered side of each stone facing down.



Figure 9. Completed speckled stone installation.

Optional Crushed Glass

The R324STIO Residential fireplace has the option of Crushed Glass. 7 bags of the media can be distributed proportionally across all three trays.



Figure 8b. Completed Crushed Glass installation.

NOTE: Do not place ANY media over the pilot cover.



Figure 9a. Do not cover pilot

Installation



Optional Driftwood Logs

The R324STIO has the option of installing a drift wood log set. Once the firestones, fireglass or speckled stones have been installed the log set can be installed.

Ensure logs are securely placed and will not tip or fall. Remove glass or stones where logs touch the burner tray to ensure a more secure position.

NO LOGS SHOULD LAY ACROSS OR OVER TOP OF THE BURNER PORTS ON THE SURFACE OF THE BURNER.

Log kits used to create sequence shown: 2 of LGS58

Step 1. Identify the logs included in each kit.



Figure 10. Contents of LGS58

Step 2. Starting from the outside edge of the fireplace, place the first log #2 diagonally across the middle and outside trays opposite to the pilot shield.

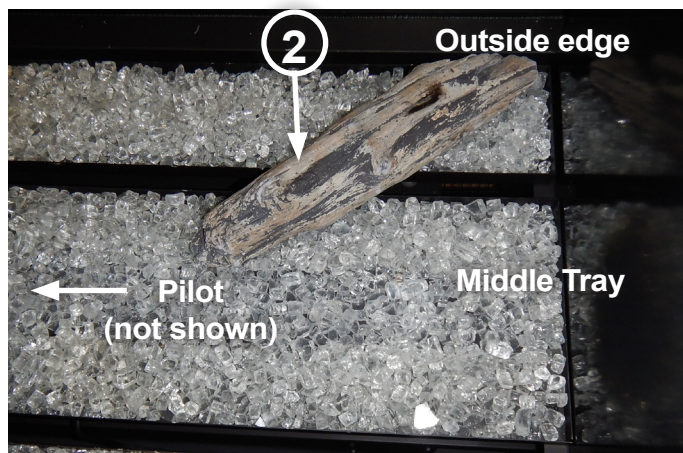

Figure 11.

Step 3. Place the first log #1 along the outer edge of the middle tray with one end resting on log #2 as shown in Figure 26.

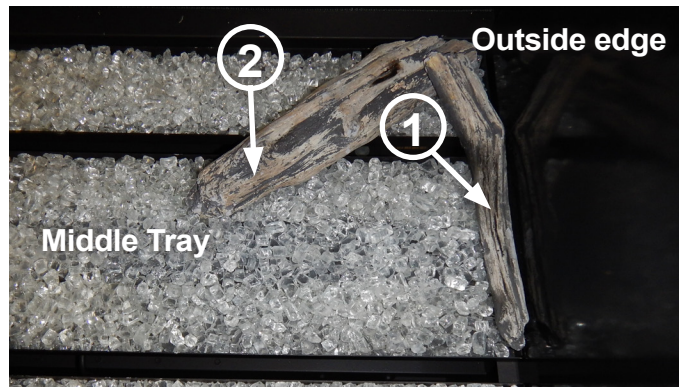

Figure 12.

Step 4. Place the first log #6 along the inside tray opposite to the pilot shield shown in Figure 27.

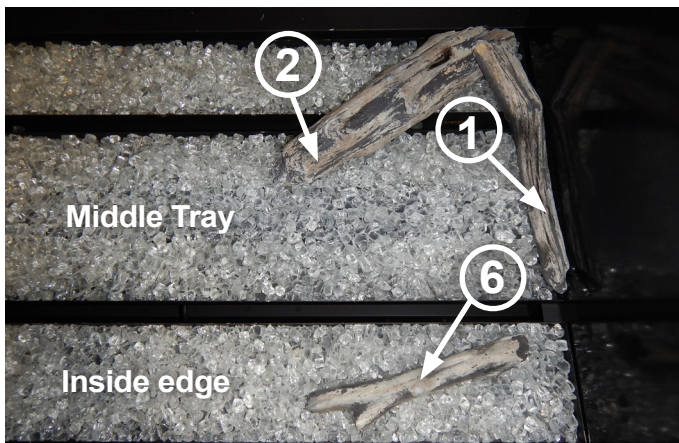

Figure 13.

Step 5. Place the second log #2 along the inside tray resting on log #6, resting right beside the burner as shown in Figure 14.

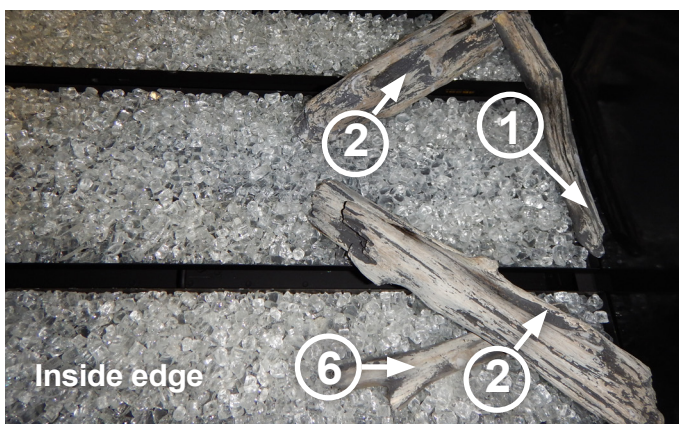

Figure 14.



Installation

Step 6. Place the first log #5 along the outer tray as shown.

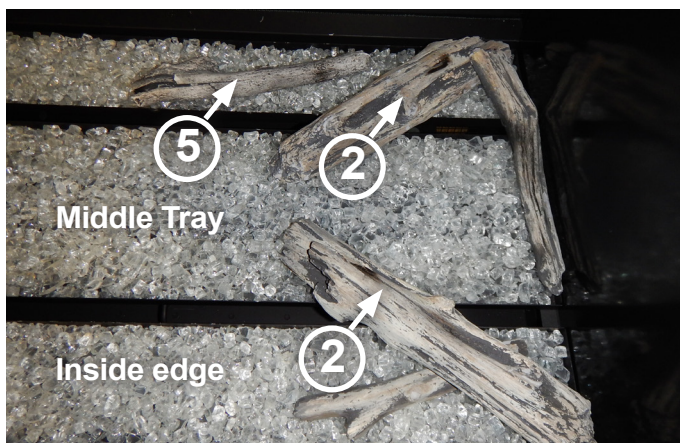

Figure 15.

Step 7. From the pilot side of the fireplace, align the first log #3 crossing from the inner tray to the middle as shown.

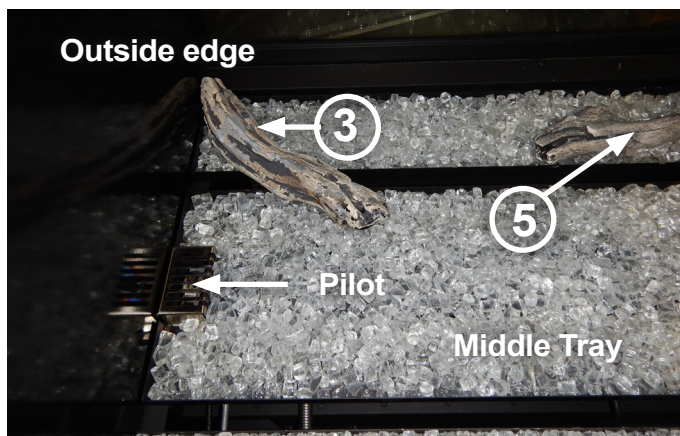

Figure 16.

Step 8. Place the second log #4 resting on log #3, crossing from the outer side of the fireplace to the middle tray as shown.

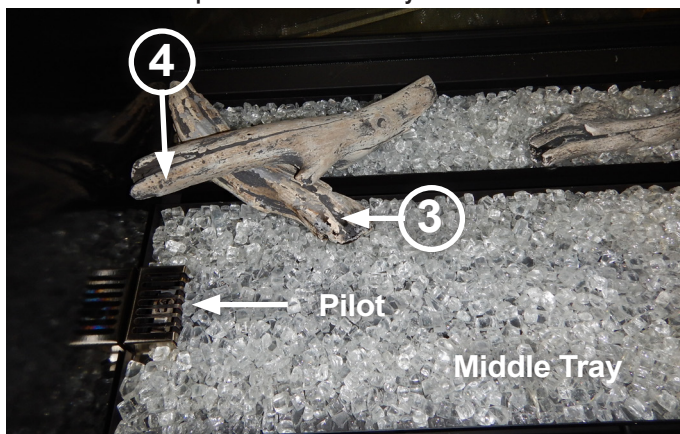

Figure 17.

Step 9. Place the second log #6 crossing from the inner side of the fireplace to the middle tray as shown. Be sure the log does not block burner ports.

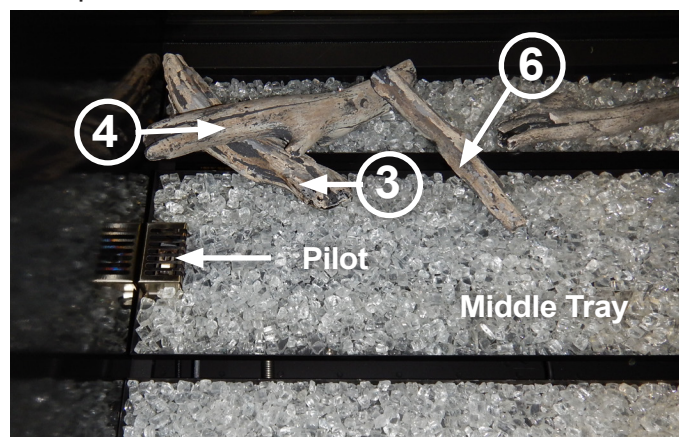

Figure 18.

Step 10. Place second log 5 next to burner on the middle tray as shown.

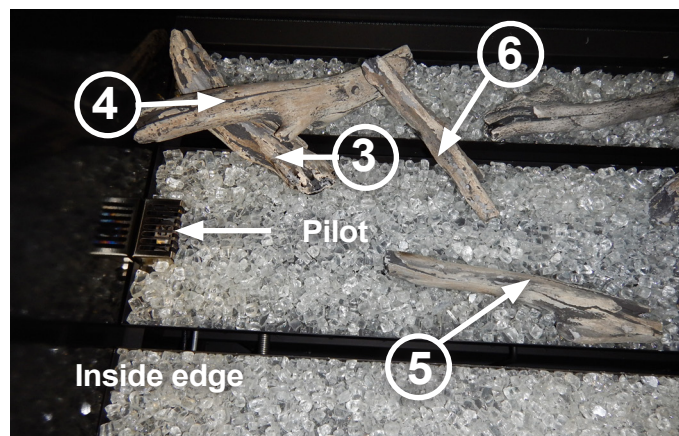

Figure 19.

Step 11. Place the second log #4 resting on log #5 crossing from the inner side of the fireplace to the middle tray as shown. Be sure the log does not block burner ports.

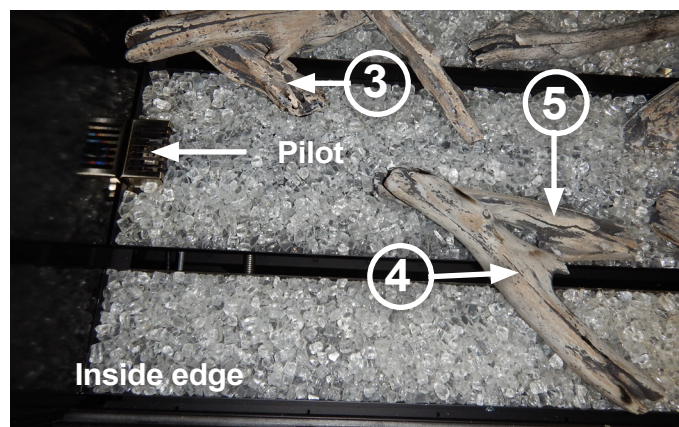

Figure 20.

Installation



Step 12. Place the second log #1 along the panel near the pilot shield as shown.

Step 13. The second log #3 rests on log #1 along the inside edge.

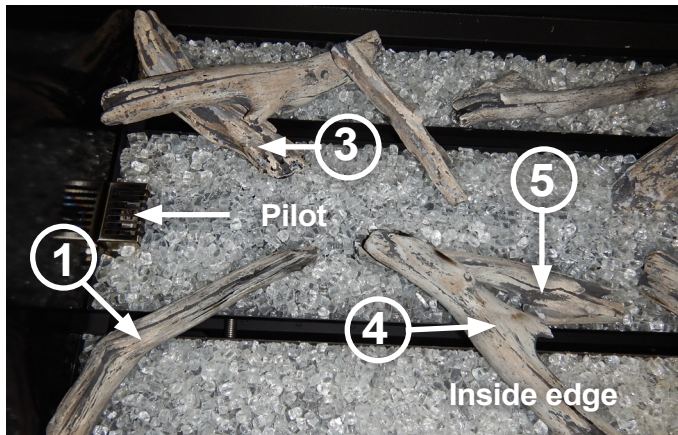

Figure 21.

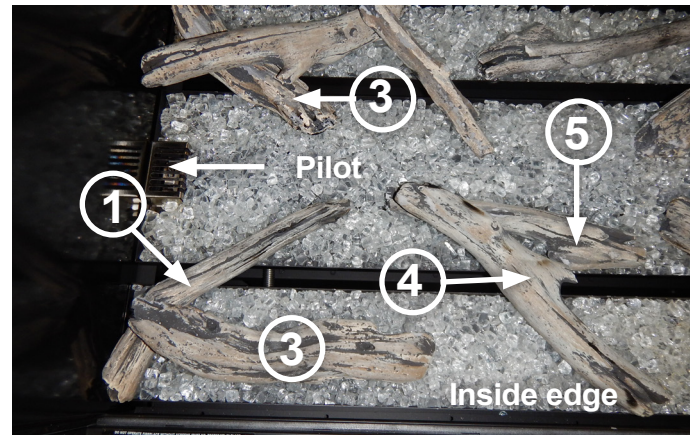

Figure 22.

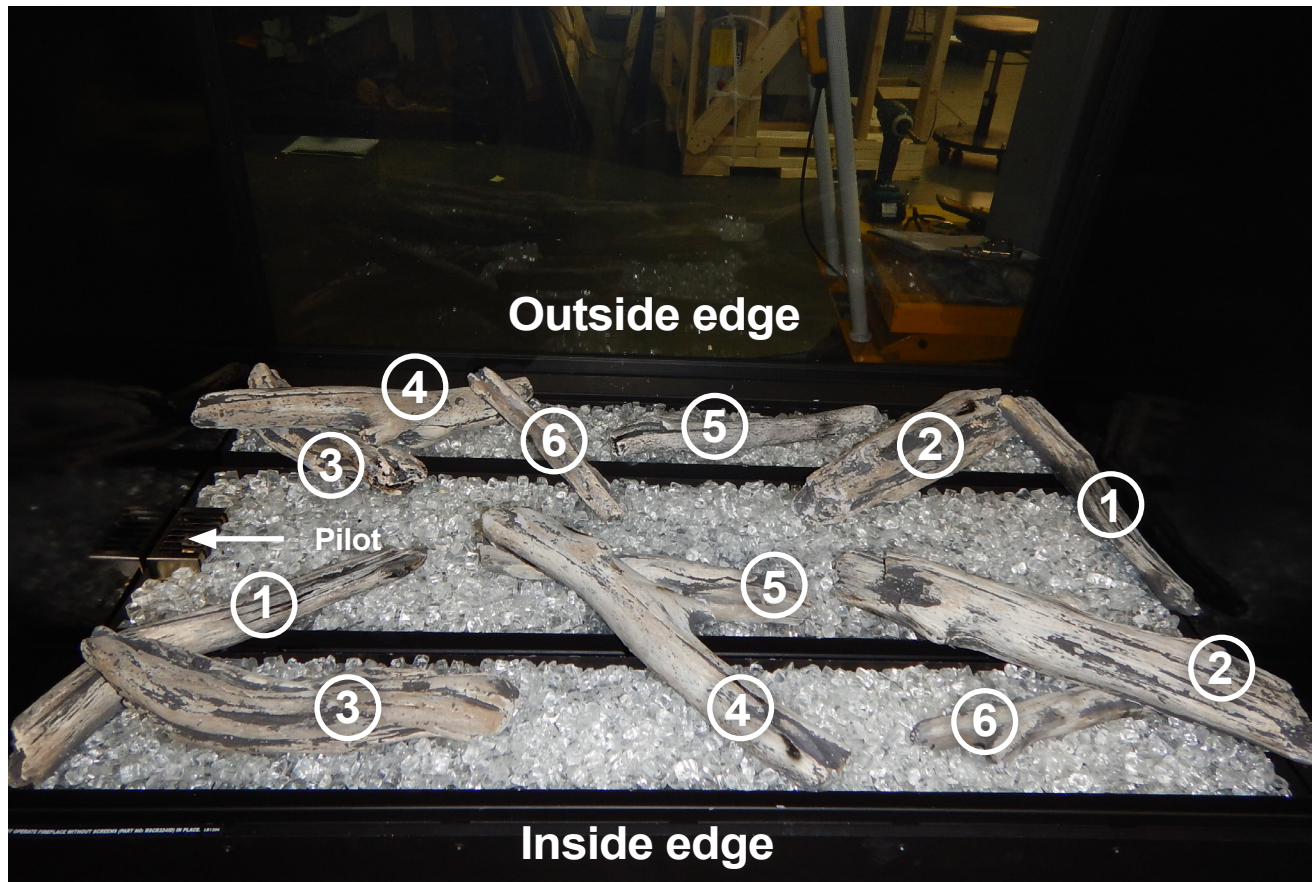

Figure 23.

Note: It is normal to see some soot build-up on logs. Soot should not build up enough to form balls. Adjust logs away from flame as necessary if this occurs.



Operation

Section 8: Start-up Sequence

FOR YOUR SAFETY - READ BEFORE LIGHTING :



DANGER



HOT GLASS WILL CAUSE BURNS.

DO NOT TOUCH GLASS UNTIL COOLED.

NEVER ALLOW CHILDREN TO TOUCH GLASS.

A barrier designed to reduce the risk of burns from the hot viewing glass is provided with this appliance and shall be installed for the protection of children and other at-risk individuals.

WARNING If the information in these instructions are not followed exactly, a fire or explosion may result causing property damage, personal injury or death.

WARNING / CAUTION: Hot while in operation. Do not touch. Severe burns may result. Keep children, clothing, furniture, gasoline and other liquids having flammable vapors away.

See installation and operating instructions accompanying this appliance.

- | | |
|--|--|
| <p>A. This appliance has a pilot which is lit automatically. Do not attempt to light the pilot by hand.</p> <p>B. BEFORE LIGHTING smell all around the appliance area for gas. Be sure to smell next to the floor because some gas is heavier than air and will settle on the floor.</p> <p>What To Do If You Smell Gas:</p> <ul style="list-style-type: none"> ■ Do not try to light the appliance. ■ Do not touch any electrical switch. Do not use any phone in your building. ■ Immediately call your gas supplier from a neighbour's phone. Follow the gas suppliers instructions. | <ul style="list-style-type: none"> ■ If you cannot reach your gas supplier, call the Fire Department. <p>C. Use only your hand to push in or turn the gas control knob. Never use tools. If the knob will not push in or turn by hand, don't try to repair it. Call a qualified service technician. Force or attempt to repair may result in a fire or explosion.</p> <p>D. Do not use this appliance if any part has been under water. Immediately call a qualified service technician to inspect the appliance and to replace any part of the control system, and any gas control which has been under water.</p> |
|--|--|

LIGHTING INSTRUCTIONS:

1. **STOP!** Read the safety information above on this label.
2. Turn the fireplace "OFF" using the wall switch or remote control.
3. Wait 5 minutes to clear out any gas. If you smell gas, **STOP!** Follow "B" in the safety information above on this label. If you don't smell gas, go to the next step.
4. Turn the fireplace "ON" using the wall switch or remote control.
5. The wall switch LED and heat sensor/combustion air LED will light up.
6. Once the predetermined airflow is established in the firebox, the flue gas switch LED will light up after 30 seconds.
7. After approximately 1 minute the hot surface igniter will start to glow. The pilot will light up, followed by the main burner. The fireplace will then start up.

NOTE: This unit is equipped with an ignition system that lights the pilot burner automatically. Do not attempt to light the pilot by hand.

This unit is equipped with advanced safety controls including pre and post purge timers. The fireplace will not turn on until all of the safety conditions are met. The fans in the fireplace may operate for an extended period of time even after the wall switch is turned off.

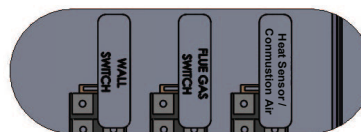

Control box LED lights

NOTE: If the igniter does not glow, even after 3 minutes have passed, follow the instructions "To Turn Off Gas To Appliance" and call your service technician or Montigo dealer.

TO TURN OFF GAS TO APPLIANCE:

1. Turn the fireplace off using the wall switch or remote control.
2. Turn off all electrical power to the appliance.
3. Locate the gas shut off valve for the appliance and turn off.

P/N LB1174-112614

Maintenance



Section 9: Cleaning and Maintenance

General

- Have the fireplace and installation inspected yearly. The inspection must include, but is not limited to, the following:
 - A visual check of the exhaust intake area for blockage.
 - An inspection of the door gasket to ensure a proper seal.
 - An inspection of the burner, media placement, and primary air openings.
 - An inspection of the gas valve, gas components, and pilot flame. Inspect for corrosion of firebox and other components.
 - Inspection of all optional equipment; fans, thermostats, etc.
 - Confirm pre purge timer is set to one (1) minute.
- For Natural Gas this appliance requires a minimum inlet pressure of 5.5" W.C. and a manifold pressure of 3.5" W.C.
- For Propane Gas this appliance requires a minimum inlet pressure of 11" W.C. and a manifold pressure of 10" W.C.
- Always keep the fireplace area clear and free of combustible materials, as well as gasoline and other flammable vapors and liquids.
- Do not use this appliance if any part has been under water. Immediately call a qualified service technician to inspect the appliance and to replace any part of the control system and any gas control which has been under water.

Cleaning

When the fireplace is first activated, there may be some smoking and a visible film may be left on the glass. This is a normal condition, and is the result of burning of protective coatings on new metal.

- Glass must be cleaned periodically to remove any film (which is a normal by-product of combustion) which may be visible. Film can easily be removed by removing the door, as shown on Page 11. Handle the door carefully, and clean it with non-abrasive glass cleaners. One of the most effective products is Kel Kem.
- Use a vacuum cleaner or whisk broom to keep the control compartment, exhaust area and firebox free from dust and lint.

NOTICE

Do not use ammonia based or abrasive cleaners on the glass, they will permanently etch the surface. Use an approved gas fireplace glass cleaner such as Kel-Kem or White off.

Procedure for checking calibration of air switch

1. Turn off gas
2. Remove indoor glass and burner tray so that air switch LED is visible.
3. Turn wall switch 'ON'.
4. Reduce the fan speed by turning speed dial clockwise. Ensure LED (R3) turns off when fan is turned off.

Gas Control Valve

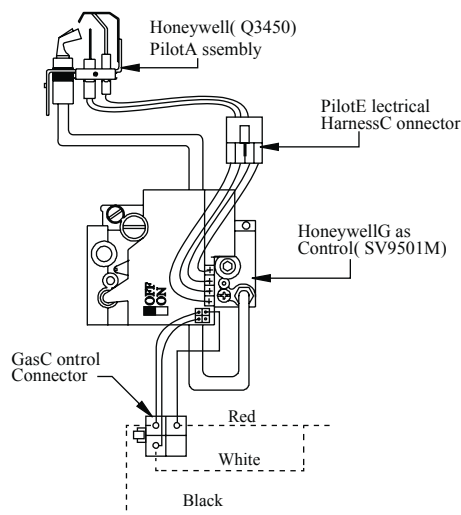

Figure 9. Gas valve.

Procedure for resetting Temperature Limit Switch

Temperature limit switch may trip if exhaust is blocked by snow, dirt, debris, etc. The following steps will enable you to reset the Temperature limit switch.

1. Ensure wall switch is 'OFF'.
2. Clear blockage (snow, dirt, debris, etc) in front of exhaust.
3. Open exhaust grill
4. With a small screw driver push red pin to reset switch.
5. Replace grill
6. Turn on fireplace



Maintenance

Section 10: Wiring

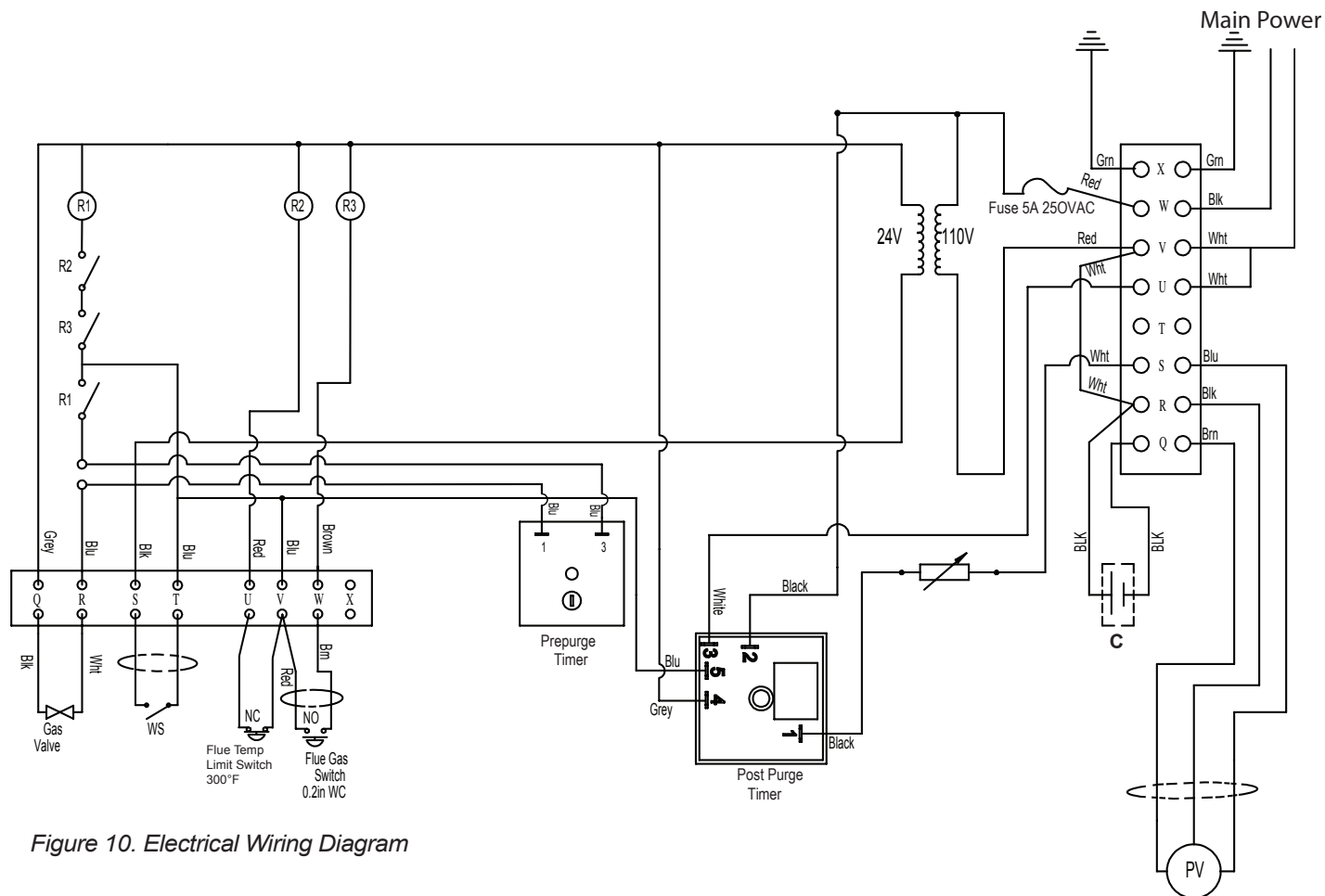

Figure 10. Electrical Wiring Diagram

Maintenance



Section 11: Accessing the Control Panel

Step 1. Remove screws that secure media tray on the indoor side of the fireplace.



Figure 11. Removing screws that secure media tray



Figure 11a. Removing screws that secure media tray

Step 2. Remove the media tray by lifting up and out.



Figure 11b. *Note placement of rating plate

Step 3. Remove the screws from each side and the middle of the control panel cover.

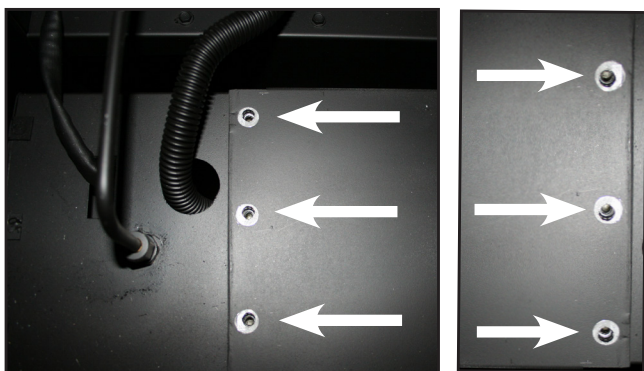

Figure 11c. Removing screws from each side of the control panel cover

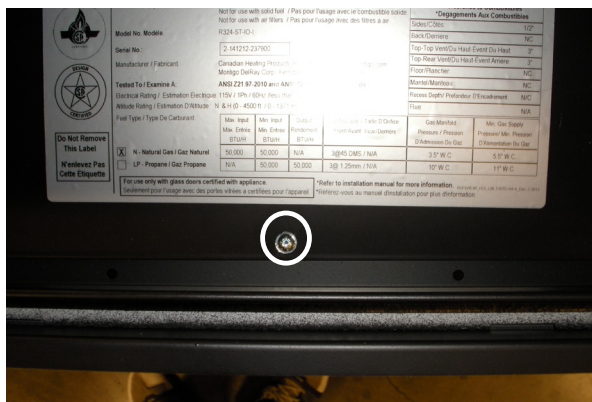

Figure 11d. Removing screw from middle of control panel cover

Step 4. Lift control panel cover out to expose controls.

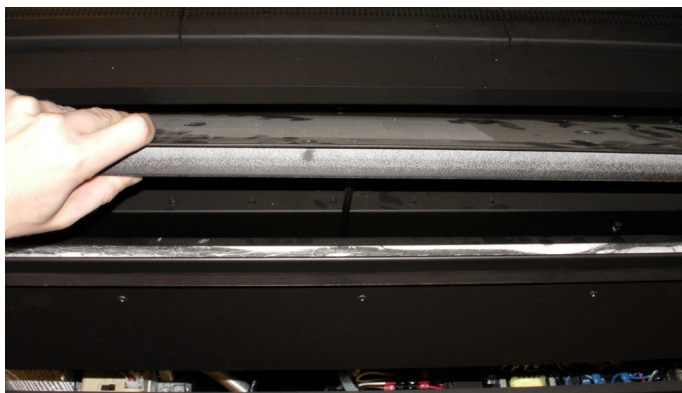

Figure 11e. Exposing controls under control panel



Figure 11f. Control box controls

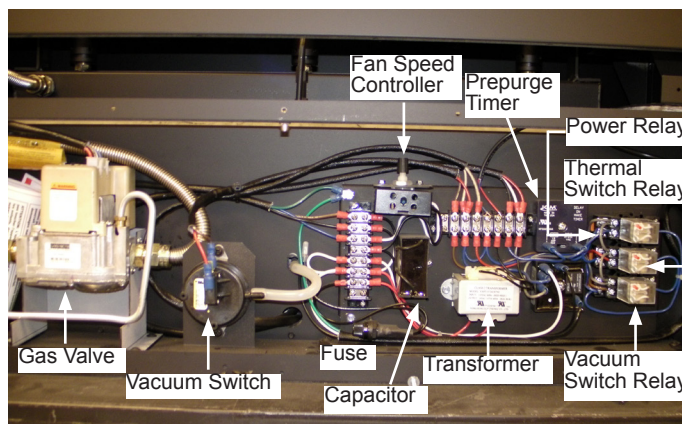

Figure 11g. Control box controls



Maintenance

Replacement Parts

Honeywell HSI	
	R324-ST
NG Gas Valve	RGC1004
LP Gas Valve	RGC1003
NG Pilot Assembly	RPA003-30
LP Pilot Assembly	RPA004-30
Power Vent Control Box	RESCB2
Replacement Screen	RSCR320
Fuse, AGC-5Amp	EC1122
275 deg F Manual Reset Switch	EC1073
Vacuum Switch	REC1226
Outdoor Glass (for fireplace without screen)	RD324ST01
Outdoor Glass (for fireplace with screen)	RDT324OD
Indoor Glass	RD324ST02
Outdoor Screen	RSCR324OD
Indoor Screen	RSCR324ID

Appendix

Appendix A: Warranty

The Warranty

The Companies warrants the Montigo Gas Appliance to be free from defects in materials and workmanship at the time of manufacture. On the Montigo fireplace, there is a ten-year warranty on the firebox and its components, a five-year warranty on the main burner and pilot burner, and a one-year warranty on the gas control valve, fibre logs and Power Vent Module. The Glass, plated / painted finishes, and refractory lining are exempt from the warranty.

Remedy And Exclusions

The coverage of this Warranty is limited to all components of the Gas Appliance manufactured by The Companies.

This Warranty only covers Montigo Gas Appliances installed in the United States or Canada.

If the components of the Gas Appliance covered by this Warranty are found to be defective within the time frame stated (see The Companies right of investigation outlined below). The Companies will, at its option, replace or repair defective components of the Gas Appliance manufactured by The Companies at no charge, and will also pay for reasonable labour costs incurred in replacing or repairing components. If repair or replacement is not commercially practical, The Companies will, at its option, refund the purchase price of the Montigo Gas Appliance.

This Warranty covers only parts and labour as provided above. In no case shall The Companies be responsible for materials, components, or construction which are not manufactured or supplied by The Companies, or for the labour necessary to install, repair or remove such materials, components or construction. All replacement or repair components will be shipped F.O.B. the nearest The Companies factory.

Qualifications To The Warranty

The Gas Appliance Warranty outlined above is further subject to the following qualifications:

- (1) The Gas Appliance must be installed in accordance with The Companies installation instructions and local building codes. The Warranty on this Montigo Gas Appliance covers only the component parts manufactured by The Companies. The use of components manufactured by others with this Montigo Gas Appliance could create serious safety hazards, may result in the denial of certification by recognized national safety agencies, and could be in violation of local building codes. This warranty does not cover any damages occurring from the use of any components not manufactured or supplied by The Companies
- (2) The Montigo Gas Appliance must be subjected to normal use. The Gas Appliances are designed to burn gas only. Burning conventional fireplace fuels such as wood, coal or any other solid fuel will cause damage to the Gas Appliance, will produce excessive temperatures and will result in a fire hazard.

Limitations On Liability

It is expressly agreed and understood that The Companies sole obligation, and purchaser's exclusive remedy under this Warranty, under any other warranty, expressed or implied, or in contract, tort or otherwise, shall be limited to replacement, repair, or refund, as specified above.

In no event shall The Companies be responsible for any incidental or consequential damages caused by defects in its products, whether such damage occurs or is discovered before or after replacement or repair, and whether or not such damage is caused by The Companies negligence. Some states do not allow the exclusion or limitation of incidental or consequential damages, so the above limitation or exclusion may not apply to you. The duration of any implied warranty with respect to this Montigo Gas Appliance is limited to the duration of the foregoing warranty. Some states do not allow limitation on how long an implied warranty lasts, so the above may not apply to you.

Investigation Of Claims Against Warranty

The Companies reserves the right to investigate any and all claims against this Warranty and to decide upon method of settlement.

The Companies Are Not Responsible For Work Done Without Written Consent

The Companies shall in no event be responsible for any warranty work done without first obtaining The Companies written consent.

Dealers Have No Authority To Alter This Warranty

The Companies employees and dealers have no authority to make any warranties nor to authorize any remedies in addition to or inconsistent with those stated above.

How To Register A Claim Against Warranty

In order for any claim under this Warranty to be valid, The Companies must be notified of the claimed defect in writing or by telephone, as soon as reasonably possible after the defect is discovered. Claims against this Warranty in writing should include the date of installation, and a description of the defect.

Other Rights

This Warranty gives you specific legal rights, and you may also have other rights which vary from state to state.

NOTE: The Companies as stated above refer to - Canadian Heating Products Inc. and/or Montigo Del Ray Corp.

Canadian Heating Products Inc. and/or Montigo DelRay Corp. reserves the right to make changes at any time, without notice, in design, materials, specifications, prices and also to discontinue colors, styles and products.

Appendix

Appendix B: State of Massachusetts

Amendment

(Gas Fireplace / Equipment sold in the State of Massachusetts)

5.08: Modifications to NFPA-54, Chapter 10

(1) Revise NFPA-54 section 10.5.4.2 by adding a second exception as follows:

Existing chimneys shall be permitted to have their use continued when a gas conversion burner is installed, and shall be equipped with a manually reset device that will automatically shut off the gas to the burner in the event of a sustained back-draft.

(2) Revise 10.8.3 by adding the following additional requirements:

(a) For all side wall horizontally vented gas fueled equipment installed in every dwelling, building or structure used in whole or in part for residential purposes, including those owned or operated by the Commonwealth and where the side wall exhaust vent termination is less than seven (7) feet above finished grade in the area of the venting, including but not limited to decks and porches, the following requirements shall be satisfied:

1. INSTALLATION OF CARBON MONOXIDE DETECTORS. At the time of installation of the side wall horizontal vented gas fueled equipment, the installing plumber or gas fitter shall observe that a hard wired carbon monoxide detector with an alarm and battery back-up is installed on the floor level where the gas equipment is to be installed. In addition, the installing plumber or gas fitter shall observe that a battery operated or hard wired carbon monoxide detector with an alarm is installed on each additional level of the dwelling, building or structure served by the side wall horizontal vented gas fueled equipment. It shall be the responsibility of the property owner to secure the services of qualified licensed professionals for the installation of hard wired carbon monoxide detectors

a. In the event that the side wall horizontally vented gas fueled equipment is installed in a crawl space or an attic, the hard wired carbon monoxide detector with alarm and battery back-up may be installed on the next adjacent floor level.

b. In the event that the requirements of this subdivision can not be met at the time of completion of installation, the owner shall have a period of thirty (30) days to comply with the above requirements; provided, however, that during said thirty (30) day period, a battery operated carbon monoxide detector with an alarm shall be installed.

2. APPROVED CARBON MONOXIDE DETECTORS. Each carbon monoxide detector as required in accordance with the above provisions shall comply with NFPA 720 and be ANSI/UL 2034 listed and IAS certified.

3. SIGNAGE. A metal or plastic identification plate shall be permanently mounted to the exterior of the building at a minimum height of eight (8) feet above grade directly in line with the exhaust vent terminal for the horizontally vented gas fueled heating appliance or equipment. The sign shall read, in print size no less than one-half (1/2) inch in size, "GAS VENT DIRECTLY BELOW. KEEP CLEAR OF ALL OBSTRUCTIONS".

4. INSPECTION. The state or local gas inspector of the side wall horizontally vented gas fueled equipment shall not approve the installation unless, upon inspection, the inspector observes carbon monoxide detectors and signage installed in accordance with the provisions of 248 CMR 5.08(2)(a)1 through 4.

(b) EXEMPTIONS: The following equipment is exempt from 248 CMR 5.08(2)(a)1 through 4:

1. The equipment listed in Chapter 10 entitled "Equipment Not Required To Be Vented" in the most current edition of NFPA 54 as adopted by the Board; and

2. Product Approved side wall horizontally vented gas fueled equipment installed in a room or structure separate from the dwelling, building or structure used in whole or in part for residential purposes.

(c) **MANUFACTURER REQUIREMENTS - GAS EQUIPMENT VENTING SYSTEM PROVIDED.** When the manufacturer of Product Approved side wall horizontally vented gas equipment provides a venting system design or venting system components with the equipment, the instructions provided by the manufacturer for installation of the equipment and the venting system shall include:

1. Detailed instructions for the installation of the venting system design or the venting system components; and

2. A complete parts list for the venting system design or venting system.

(d) **MANUFACTURER REQUIREMENTS - GAS EQUIPMENT VENTING SYSTEM NOT PROVIDED.** When the manufacturer of a Product Approved side wall horizontally vented gas fueled equipment does not provide the parts for venting the flue gases, but identifies "special venting systems", the following requirements shall be satisfied by the manufacturer:

1. The referenced "special venting system" instructions shall be included with the appliance or equipment installation instructions; and

2. The "special venting systems" shall be Product Approved by the Board, and the instructions for that system shall include a parts list and detailed installation instructions.

(e) A copy of all installation instructions for all Product Approved side wall horizontally vented gas fueled equipment, all venting instructions, all parts lists for venting instructions, and/or all venting design instructions shall remain with the appliance or equipment at the completion of the installation.

(3) After NFPA-54 section 10.10.4.2 add a new section 10.10.4.3 as follows:

When more than four gas appliances are to be vented through a common gas vent or common horizontal vent manifold, a plan of the proposed vent installation shall be submitted to the Inspector and the serving gas supplier for review and approval.

Appendix

Appendix C: Canadian Installation Notice

Canadian Installations:

Canadian installations require 18" of non-combustible hearth in front of the unit and 6" below the unit. Please contact your Montigo dealer for the Canadian edition of the installation and maintenance manual or for any further information.

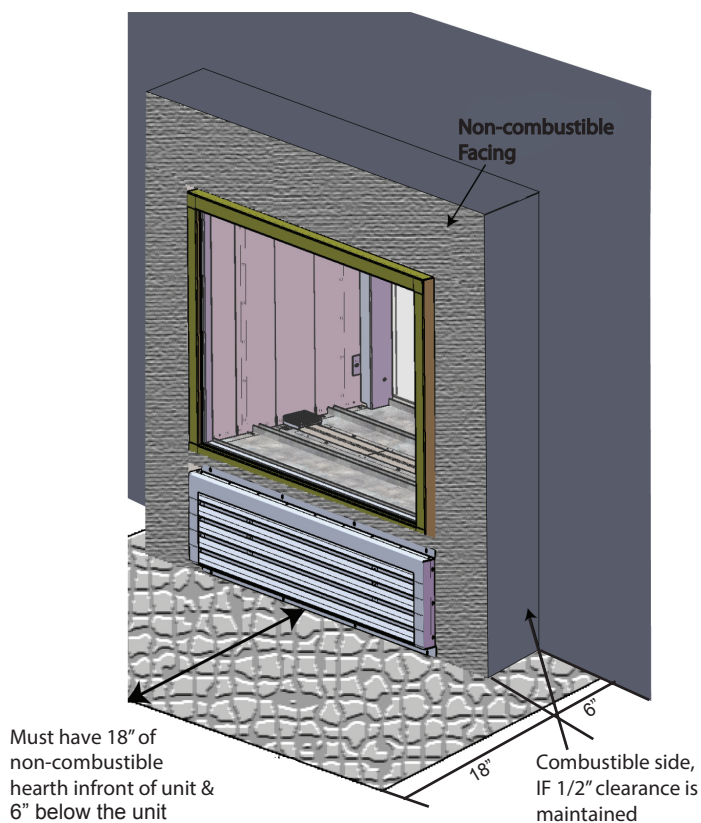



Notes

Lined area for notes, consisting of multiple horizontal lines.

Notes



R324 - ST Indoor/Outdoor Gas Fireplace USA

