



# FIRES *of Tradition*



## **Install Instructions for Cabinet Wood Mantels**

*Please read this manual before installing the suite. This manual should remain with the homeowner.*

10/04/11

*Index*

***Page #3 Installing the C channels***

***Page #4-7 Installing the Niagara Cabinet***

***Page #7-11 Installing the Riversdale Cabinet***

***Page #11-14 Installing the Kingston Cabinet***

***Page #15-17 Installing the Selby Cabinet***

***Page #18-21 Installing the Barrington Cabinet***

***Page #22 Care and Maintenance***

**Note: The fireplace manufacturer's technical specifications take precedence over any thing detailed in the following. All clearances or installation requirements detailed in the fireplace manufactures installation manual or the local building code should be strictly followed.**

## Assembling the 'C' channels & backpanels

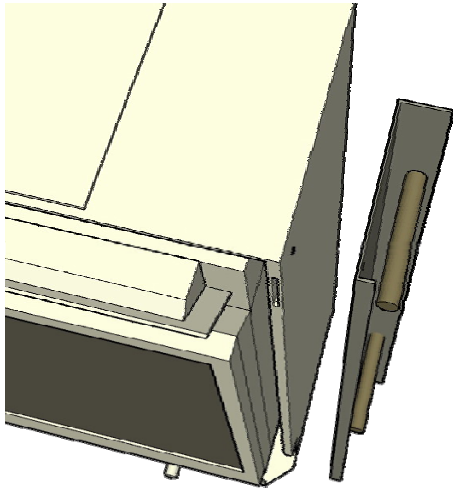

The 'C' channels are attached to the sides of the outer 530 box, and the backpanels are 'slid' down into the channels created. These backpanels are then held in place by the two threaded bolts from behind.

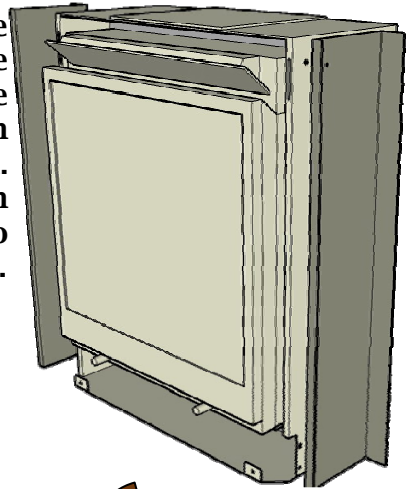

The screws that hold the C channels in place are to be run into the two holes indicated from inside the obox through the wall of the obox, and into the pre-drilled hole in the C channel. [ They will not hold in the channels in place if you run them through the C channel 'into' the side of the obox.

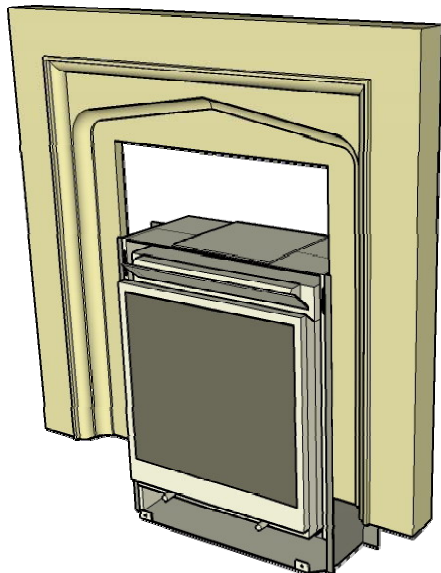
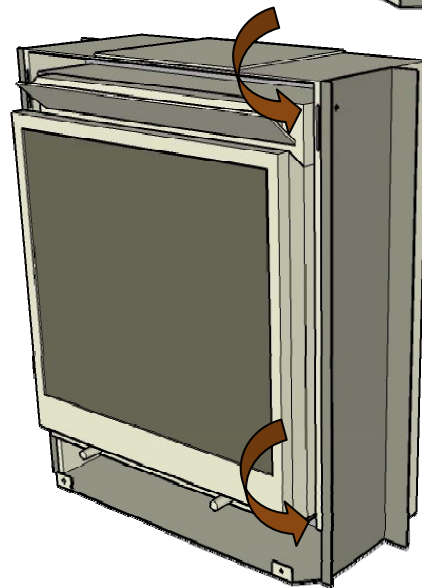

The backpanel can now be carefully lowered down the channel that is created. Insure that this is lowered evenly, and does not bind against the sides of the channel, as this may damage the inside corners of the backpanel.

Two bolts can be threaded into the back of the C channel, and firmed up against the backpanel.

Only tighten up finger tight on the backpanel!

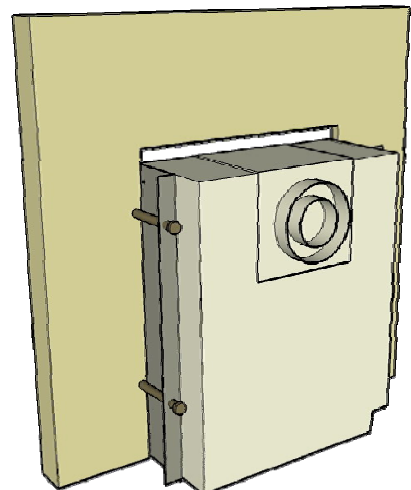

### Niagara Cabinet

- 1 pc left leg
- 1 pc right leg
- 1 pc center quoin
- 1 pc mounting cleat
- 1 pc shelf
- 4 cast grills

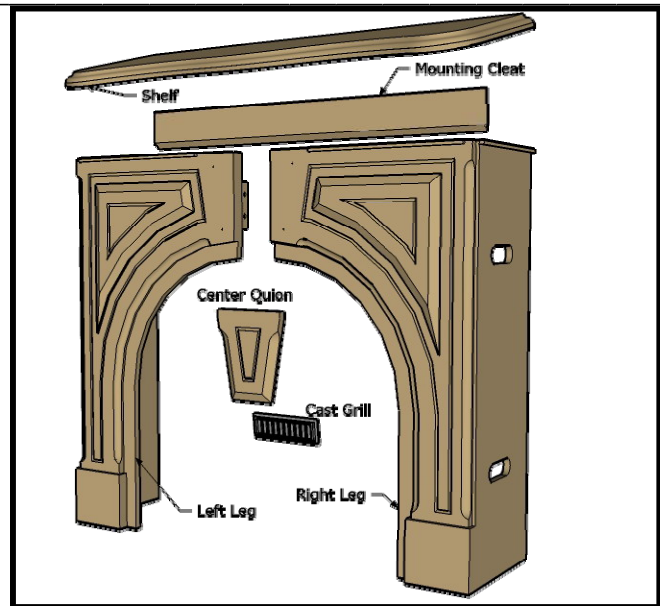

## Locating the firebox in relationship to the mantel

It is prudent to assemble some of the pcs as a dry run before you begin to install the system, to insure that you understand how all parts fit together. This is also an excellent time to check the relationship of these pcs to the firebox itself, to insure that it is installed at the correct height, and is in the correct position relative to the wall.

Carefully lay out the boxes in an area of the room where they will be out of the way, and open them up. Remove any loose packing, and with care, pull the pieces out and lay them down on the floor where they can individually be accessed.

At all times store, carry and move the hearth on edge, to avoid cracking in the middle. The hearth must be set directly on the floor. If there is a carpet, mark the perimeter of the hearth on the carpet and cut the carpet accordingly.

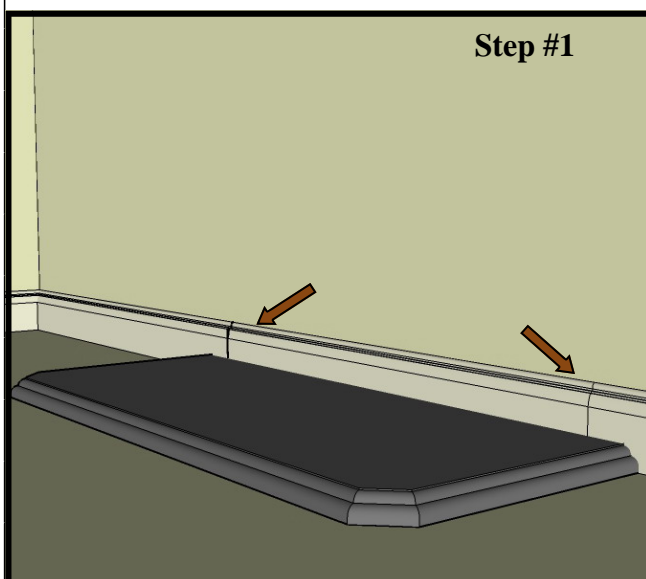

If there is a baseboard, carefully set the hearth into position and mark the baseboard where it must be cut. Make sure that the hearth is centered to the centre mark on the wall.

Assemble the mantel [see below], and set it carefully into place centered on the hearth. Mark the baseboard where the outside foot of the mantel on each side stops. Cut the baseboard accordingly. Alternatively, the baseboard can be removed and trimmed to fit the hearth and mantel once they are fully installed.

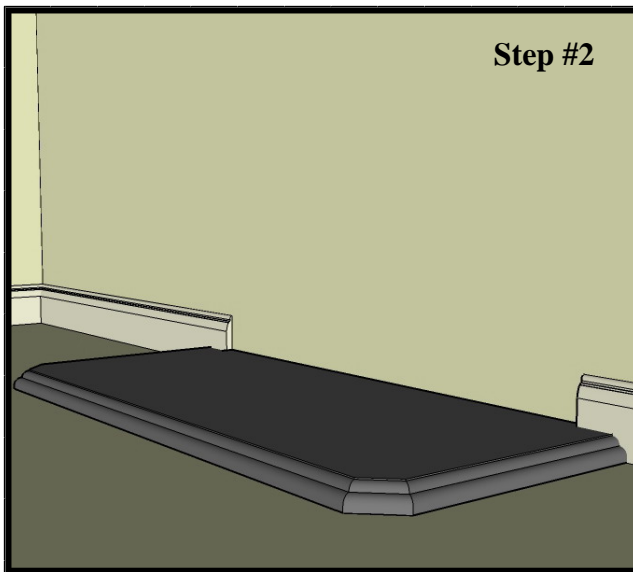

Use a fast set adhesive such as Kerakwik M to secure the hearth to the floor. Spread the adhesive across the bottom of the hearth where it comes in contact with the floor. Pick up the hearth on edge and lay the back edge against the wall. Slowly lower the leading edge and work the hearth back and forth to insure good adhesion. Wipe off excess adhesive with a damp cloth.

Insert the mounting cleat between the two legs. The two halves of the mantel can be connected together by inserting the bolts, washers, lock washers and nuts into the two wood cleats in the center of the back of the mantel.

Screw the two key holed 'L' brackets to each side of the inside return of the leg, near the top. Make sure that the keyhole is located 'upside down'.

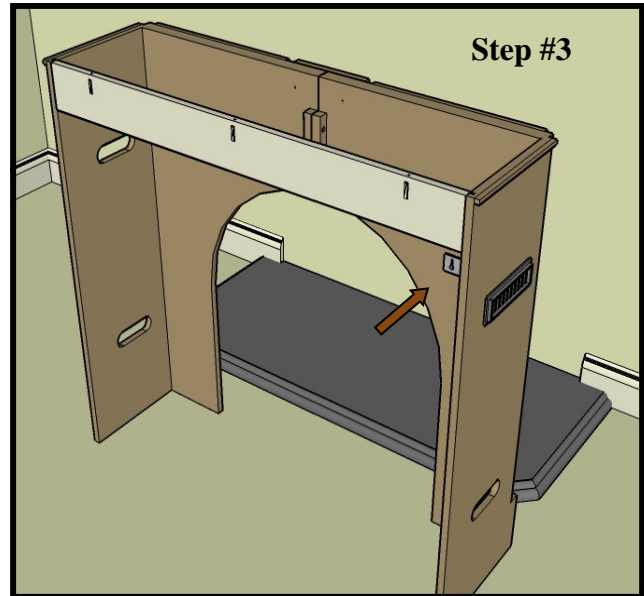

The center quoin can now be centrally positioned, and secured from behind with the 4 screws provided. Make sure that the screws are the correct length and do not protrude through the face of the quoin.

Install the 4 cast grills into the cutouts in the side of the mantel.



Set the mantel onto the hearth, and make a mark at the back of the inside opening of the mantel. Remove the mantel to the side. The 530 engine can now be installed, using this mark as the main reference point. Do a dry assembly of the Windsor front onto the 530 firebox, and set the front flat section of the Windsor plate on this line. It is this line that will determine the proper location of the firebox relative to the wall.

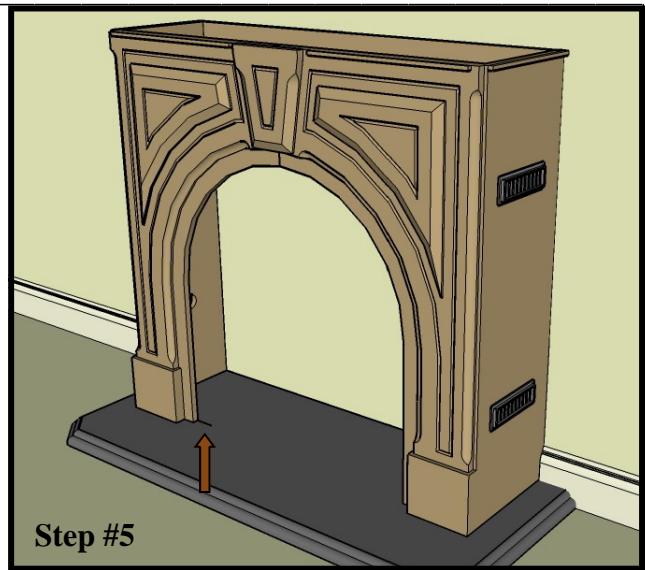

Insure that the firebox is centrally located on the hearth. Run gas line and venting, making sure that the hearth is not moved out of alignment.

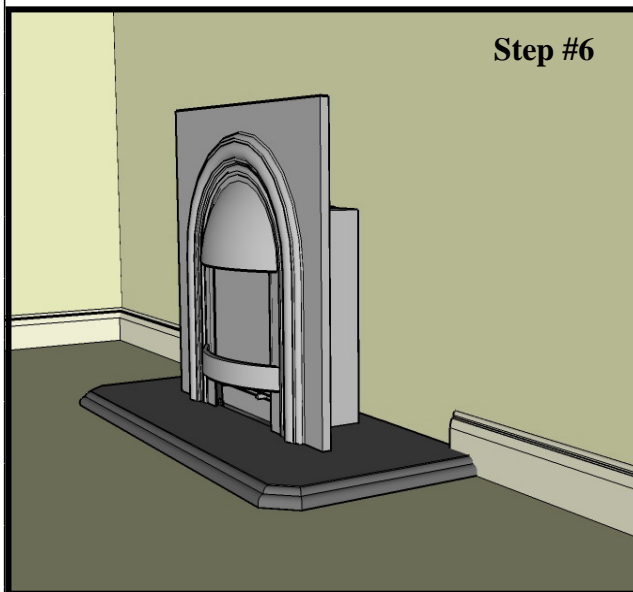

Place the mantel into final position on the wall, and mark the center of the top of the keyhole circle in the keyhole on each leg. Remove the mantel, and install the drywall plug centered on the mark you have just made. Set the screw into the wall plug so that the head is sticking out approximately 1/8" beyond the plug face. Reset the mantel into position, setting the screw head into the keyhole, and carefully allow the mantel to slid down into position.

You may have to adjust the screw head in the wall plug to insure the mantel has a snug fit against the wall.

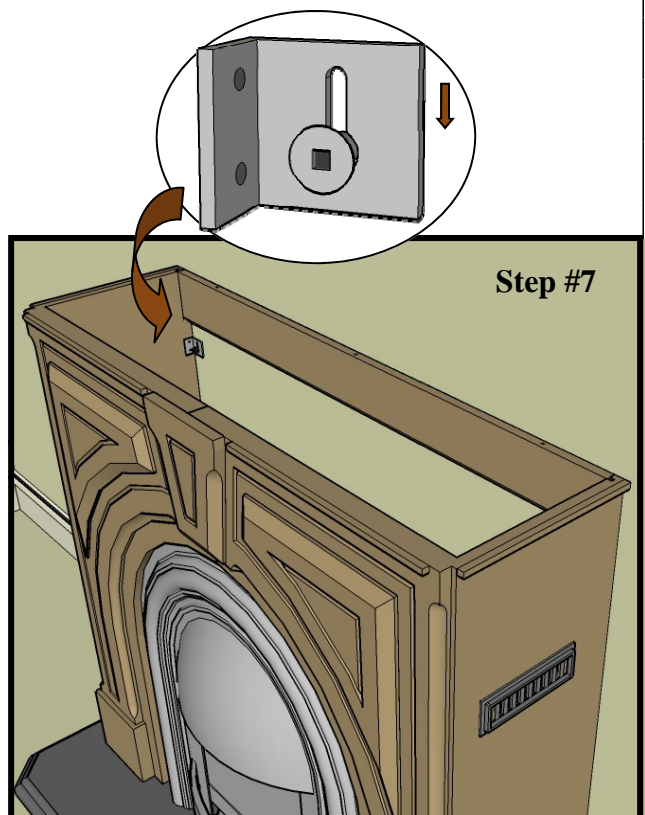

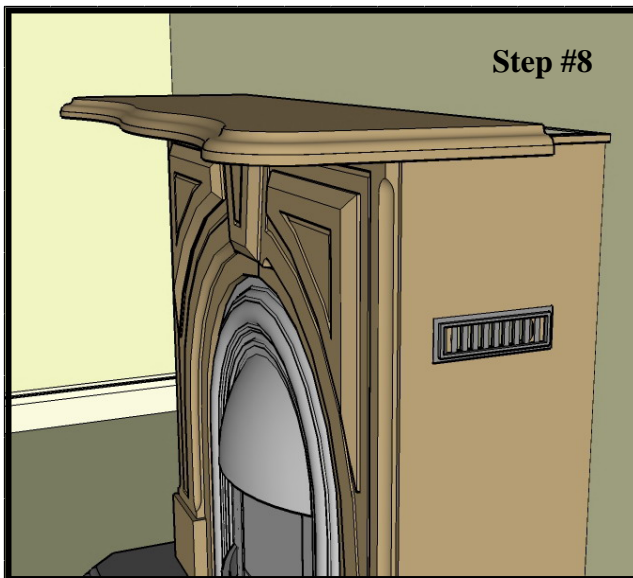

The shelf can now be slid into position, by carefully aligning it with the wooden side cleats, and gently pushing it backwards.

### **Riversdale Cabinet**

- 1 pc left leg
- 1 pc right leg
- 1 pc beam
- 2 pcs corbels
- 1 pc shelf
- 4 cast grills

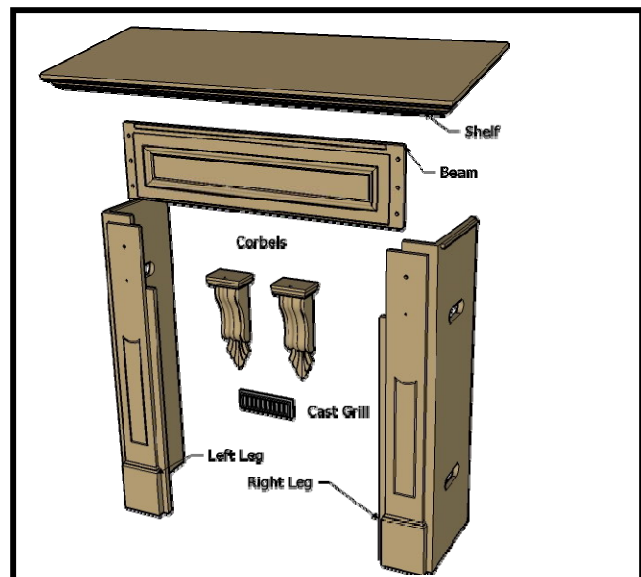

## **Locating the firebox in relationship to the mantel**

It is prudent to assemble some of the pcs as a dry run before you begin to install the system, to insure that you understand how all parts fit together. This is also an excellent time to check the relationship of these pcs to the firebox itself, to insure that it is installed at the correct height, and is in the correct position relative to the wall.

Carefully lay out the boxes in an area of the room where they will be out of the way, and open them up. Remove any loose packing, and with care, pull the pieces out and lay them down on the floor where they can individually be accessed.

At all times store, carry and move the hearth on edge, to avoid cracking in the middle. The hearth must be set directly on the floor. If there is a carpet, mark the perimeter of the hearth on the carpet and cut the carpet accordingly.

If there is a baseboard, carefully set the hearth into position and mark the baseboard where it must be cut. Make sure that the hearth is centered to the centre mark on the wall.

Assemble the mantel [see below], and set it carefully into place centered on the hearth. Mark the baseboard where the outside foot of the mantel on each side stops. Cut the baseboard accordingly. Alternatively, the baseboard can be removed and trimmed to fit the hearth and mantel once they are fully installed.

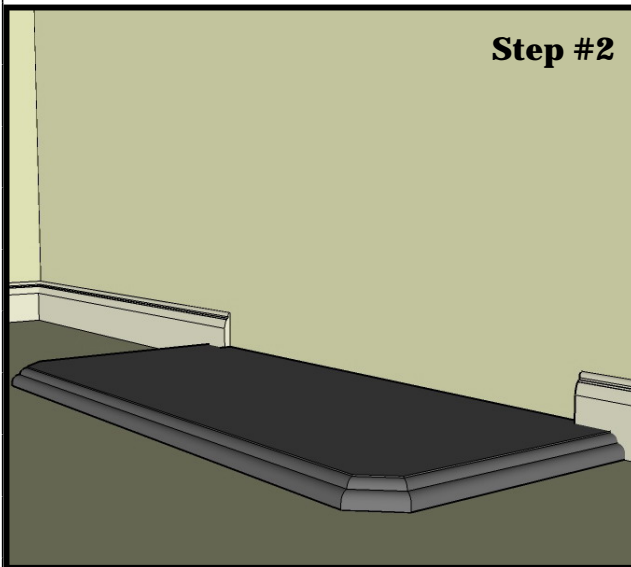
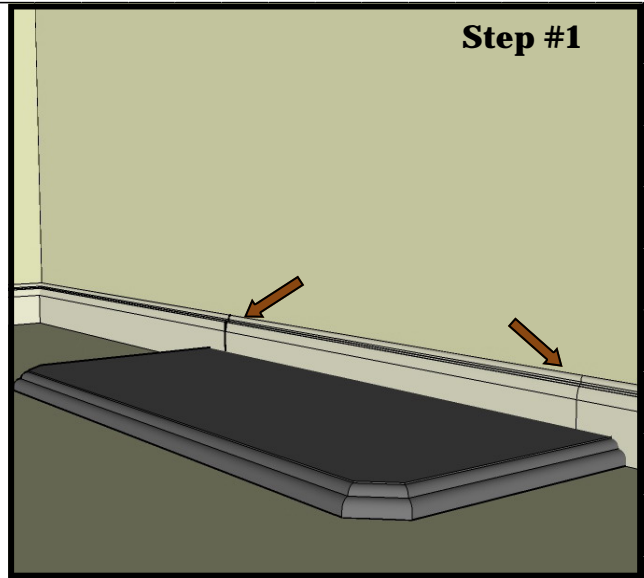

Use a fast set adhesive such as Kerakwik M to secure the hearth to the floor. Spread the adhesive across the bottom of the hearth where it comes in contact with the floor. Pick up the hearth on edge and lay the back edge against the wall. Slowly lower the leading edge and work the hearth back and forth to insure good adhesion. Wipe off excess adhesive with a damp cloth.

Install the corbels on the legs by inserting the bolt, washer and lock nut into the upper hole in the back of the mantel leg. Also install the screw in the lower hole which locks the corbel into position.





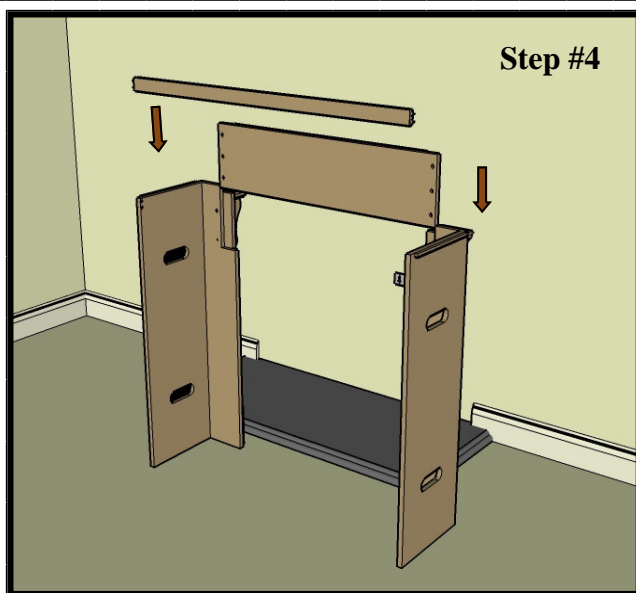

Screw the two key holed 'L' brackets to each side of the inside return of the leg, near the top. Make sure that the keyhole is located 'upside down'.

Once you have installed both corbels, carefully set the center beam and the mounting cleat into position. From the back of the mantel, secure the beam by using the 3 screws provided into the three holes on each side of the beam.

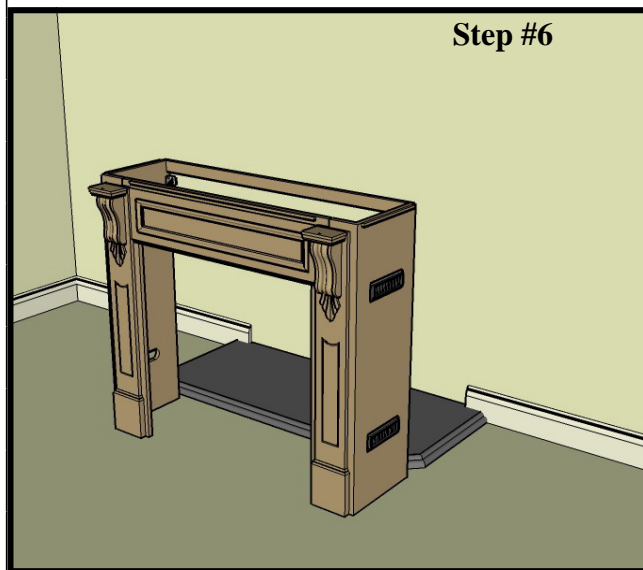
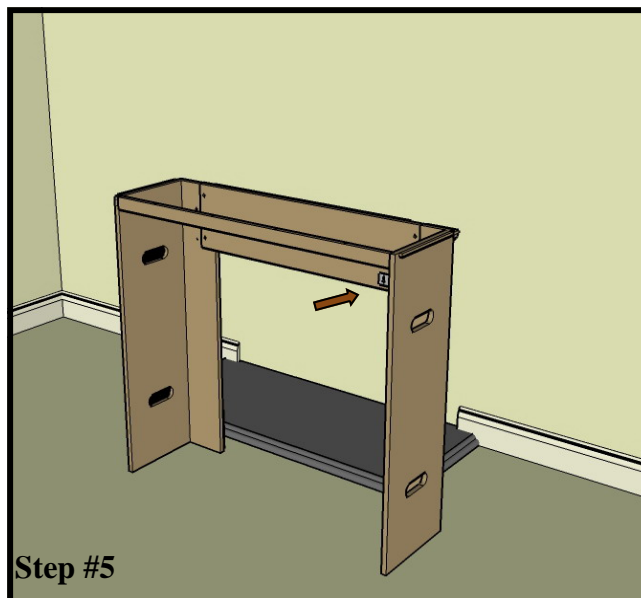

Install the 4 cast grills into the cutouts in the side of the mantel.

Set the mantel onto the hearth, and make a mark at the back of the inside opening of the mantel. Remove the mantel to the side. The 530 engine can now be installed, using this mark as the main reference point. Do a dry assembly of the front that is to be installed onto the 530 firebox, and set the front flat section of the backing plate [the area that will butt up against the back of the mantel opening] onto this line. It is this line that will determine the proper location of the firebox relative to the wall.

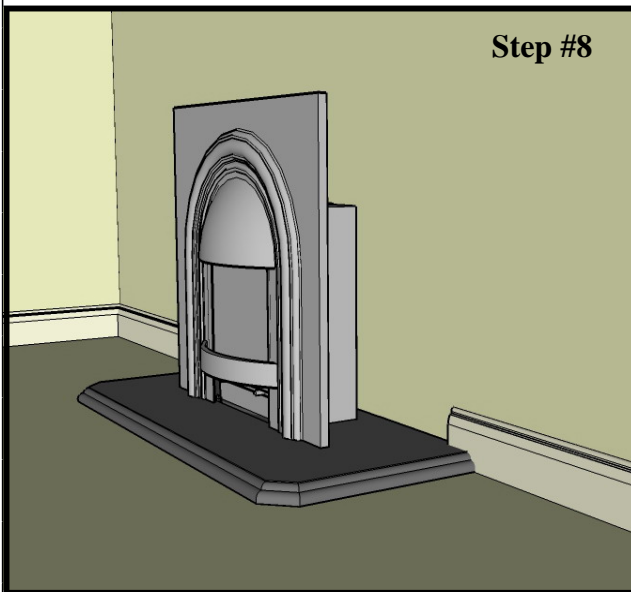

If installing the Tudor Vine, shaped or plain granite backpanels, or the cast plates, see page 3 of this guide for C channel installation.

Insure that the firebox is centrally located on the hearth. Run gas line and venting, making sure that the hearth is not moved out of alignment.

Place the mantel into final position on the wall, and mark the center of the top of the keyhole circle in the keyhole on each leg. Remove the mantel, and install the drywall plug centered on the mark you have just made. Set the screw into the wall plug so that the head is sticking out approximately 1/8" beyond the plug face. Reset the mantel into position, setting the screw head into the keyhole, and carefully allow the mantel to slid down into position.

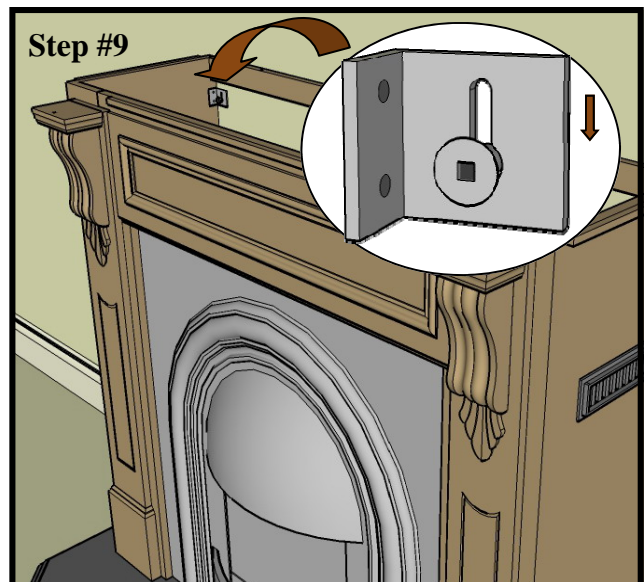

You may have to adjust the screw head in the wall plug to insure the mantel has a snug fit against the wall.

The shelf can now be slid into position, by carefully aligning it with the wooden side cleats, and gently pushing it backwards.

**Step #10**

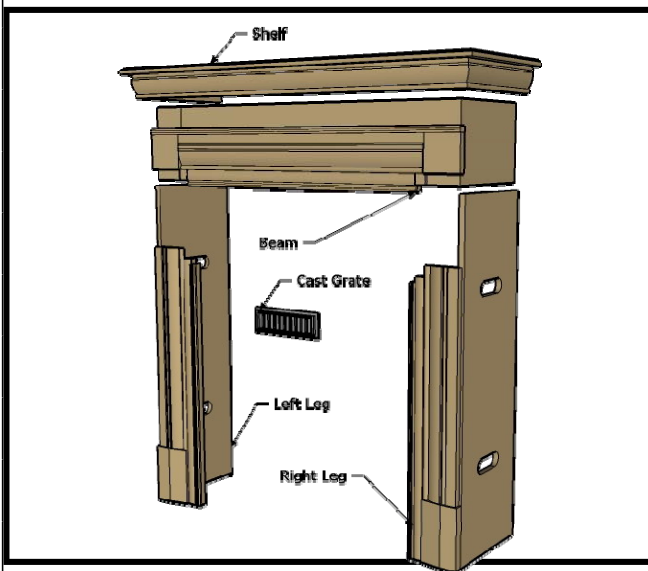
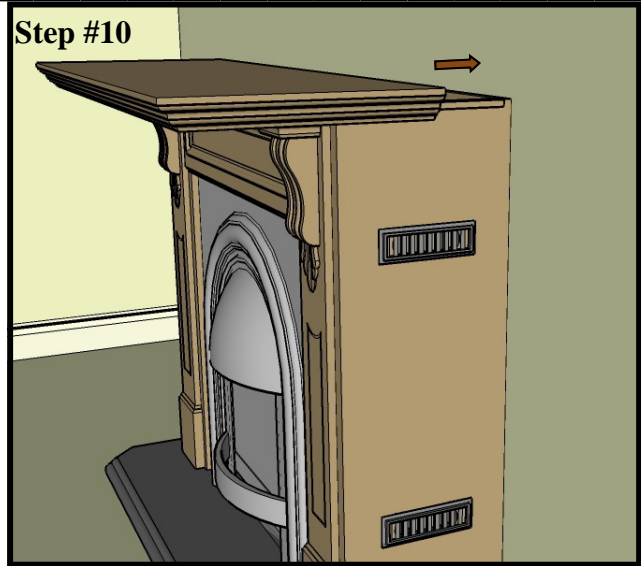

### **Kingston Cabinet**

- 1 pc left leg
- 1 pc right leg
- 1 pc shelf
- 1 pc beam
- 4 cast grills

## **Locating the firebox in relationship to the mantel**

It is prudent to assemble some of the pcs as a dry run before you begin to install the system, to insure that you understand how all parts fit together. This is also an excellent time to check the relationship of these pcs to the firebox itself, to insure that it is installed at the correct height, and is in the correct position relative to the wall.

Carefully lay out the boxes in an area of the room where they will be out of the way, and open them up. Remove any loose packing, and with care, pull the pieces out and lay them down on the floor where they can individually be accessed.

At all times store, carry and move the hearth on edge, to avoid cracking in the middle. The hearth must be set directly on the floor. If there is a carpet, mark the perimeter of the hearth on the carpet and cut the carpet accordingly.

If there is a baseboard, carefully set the hearth into position and mark the base board where it must be cut. Make sure that the hearth is centered to the centre mark on the wall.

Assemble the mantel [see below], and set it carefully into place centered on the hearth. Mark the baseboard where the outside foot of the mantel on each side stops. Cut the baseboard accordingly. Alternatively, the baseboard can be removed and trimmed to fit the hearth and mantel once they are fully installed.

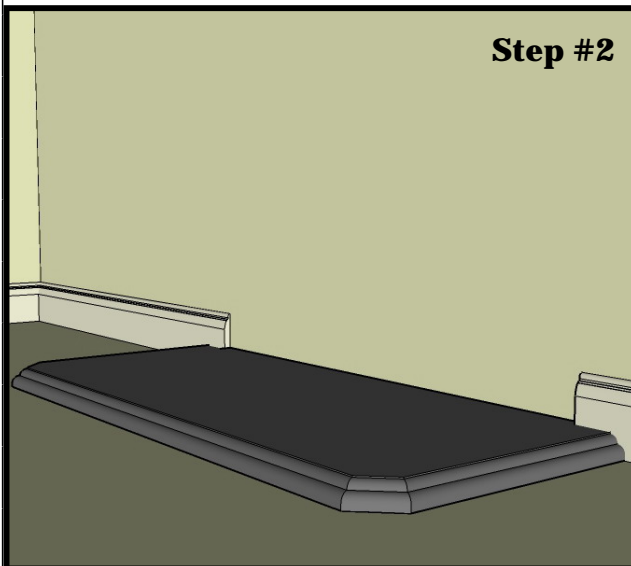
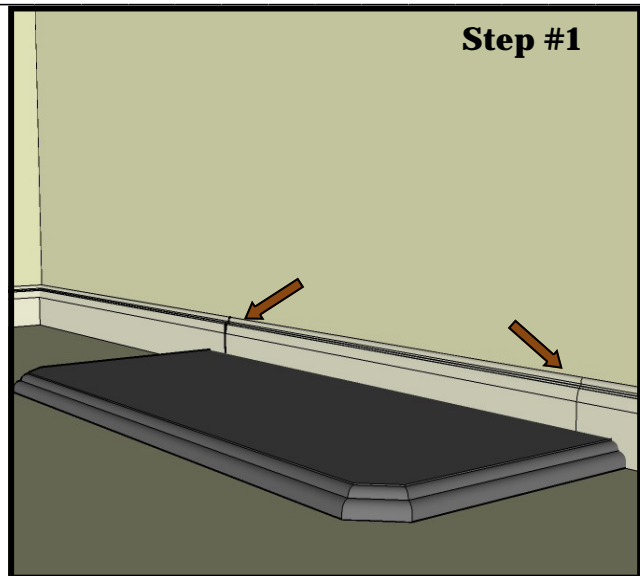

Use a fast set adhesive such as Kerakwik M to secure the hearth to the floor. Spread the adhesive across the bottom of the hearth where it comes in contact with the floor. Pick up the hearth on edge and lay the back edge against the wall. Slowly lower the leading edge and work the hearth back and forth to insure good adhesion. Wipe off excess adhesive with a damp cloth.

Set the two legs into position, and slide the beam down carefully onto the two leg tops. Secure this in place with the screws provided by running four of the screws through the inside of the beam into the holes provided in the inside of the leg.



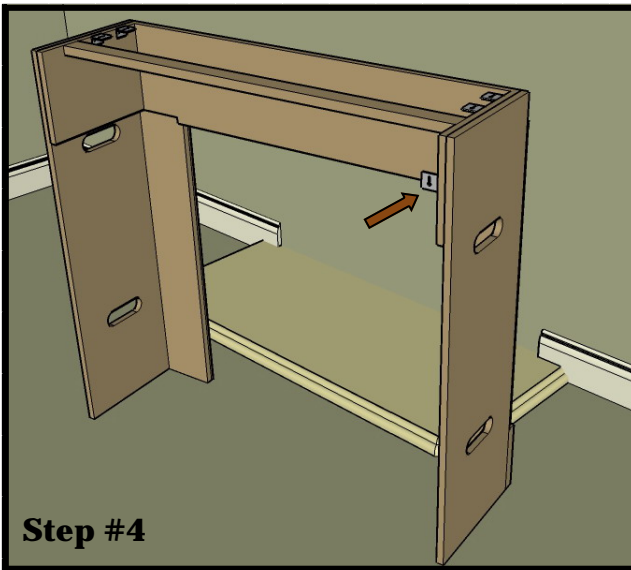

**Step #4**

Screw the 4 cast grills into the cutouts in the side of the mantel.

Screw the two key holed 'L' brackets to each side of the inside return of the leg, near the top. Make sure that the keyhole is located 'upside down'.

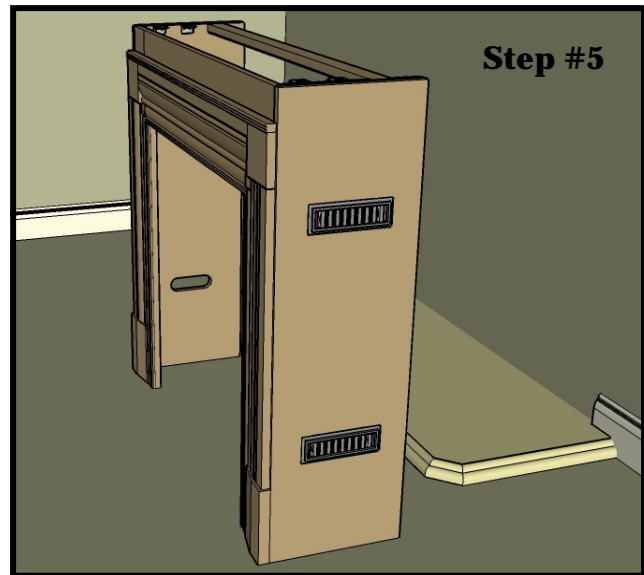

**Step #5**

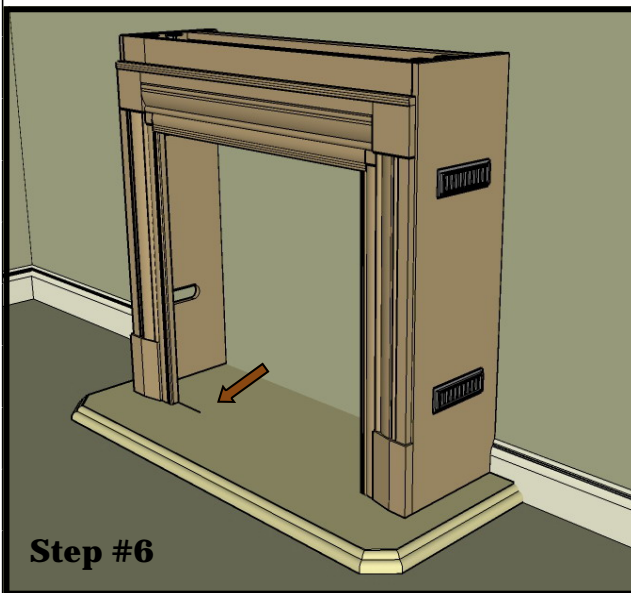

**Step #6**

Set the mantel onto the hearth, and make a mark at the back of the inside opening of the mantel. Remove the mantel to the side. The 530 engine can now be installed, using this mark as the main reference point. Do a dry assembly of the front that is to be installed onto the 530 firebox, and set the front flat section of the backing plate [the area that will butt up against the back of the mantel opening] onto this line. It is this line that will determine the proper location of the firebox relative to the wall.



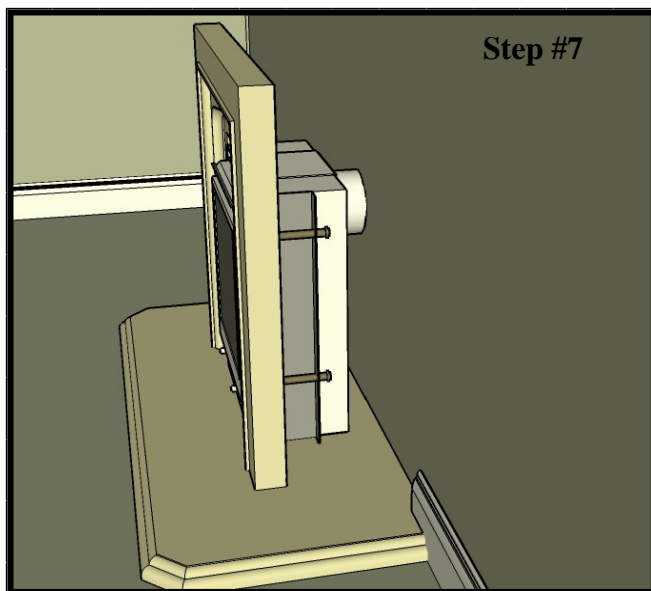

Place the mantel into final position on the wall, and mark the center of the top of the keyhole circle in the keyhole on each leg. Remove the mantel, and install the drywall plug centered on the mark you have just made. Set the screw into the wall plug so that the head is sticking out approximately 1/8" beyond the plug face. Reset the mantel into position, setting the screw head into the keyhole, and carefully allow the mantel to slid down into position.

Insure that the firebox is centrally located on the hearth. Run gas line and venting, making sure that the hearth is not moved out of alignment. If installing the Tudor Vine, shaped or plain granite backpanels, or the cast plates, see page 3 of this guide for C channel installation.

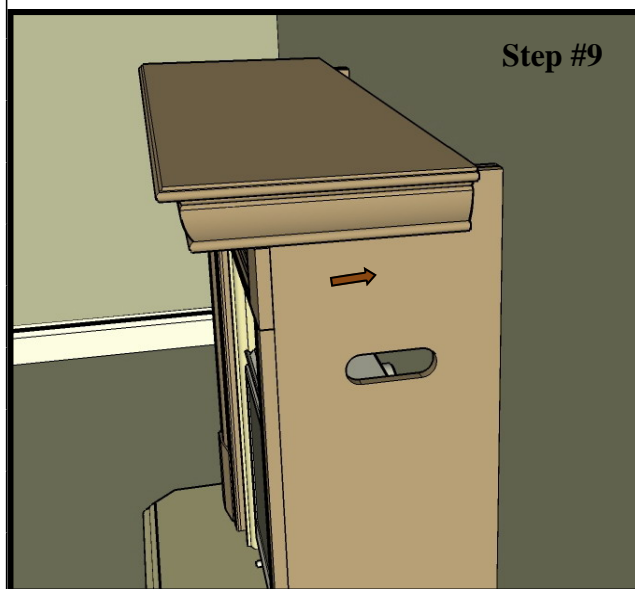
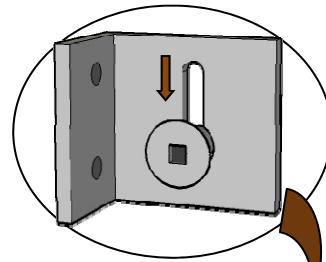

You may have to adjust the screw head in the wall plug to insure the mantel has a snug fit against the wall.

The shelf can now be slid into position, by carefully aligning it with the metal cleats, and gently pushing it backwards.

### Selby Cabinet

- 1 pc shelf
- 1 pc beam trim
- 1 pc left leg
- 1 pc right leg
- 1 pc center quoin
- 2 pcs corbels
- 4 pcs cast grills

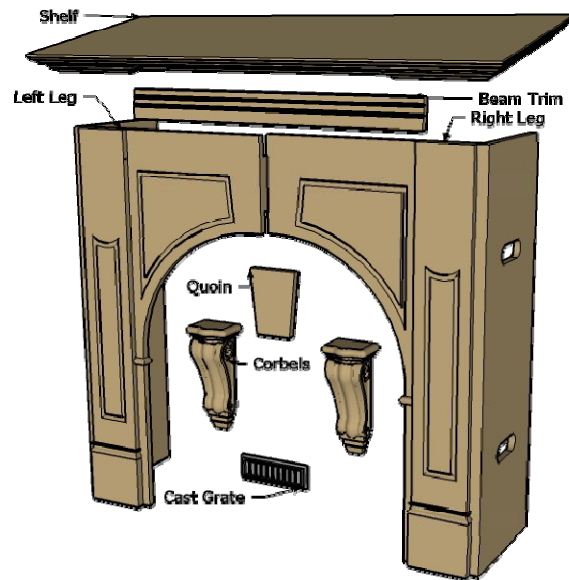

## Locating the firebox in relationship to the mantel

It is prudent to assemble some of the pcs as a dry run before you begin to install the system, to insure that you understand how all parts fit together. This is also an excellent time to check the relationship of these pcs to the firebox itself, to insure that it is installed at the correct height, and is in the correct position relative to the wall.

Carefully lay out the boxes in an area of the room where they will be out of the way, and open them up. Remove any loose packing, and with care, pull the pieces out and lay them down on the floor where they can individually be accessed.

At all times store, carry and move the hearth on edge, to avoid cracking in the middle. The hearth must be set directly on the floor. If there is a carpet, mark the perimeter of the hearth on the carpet and cut the carpet accordingly.

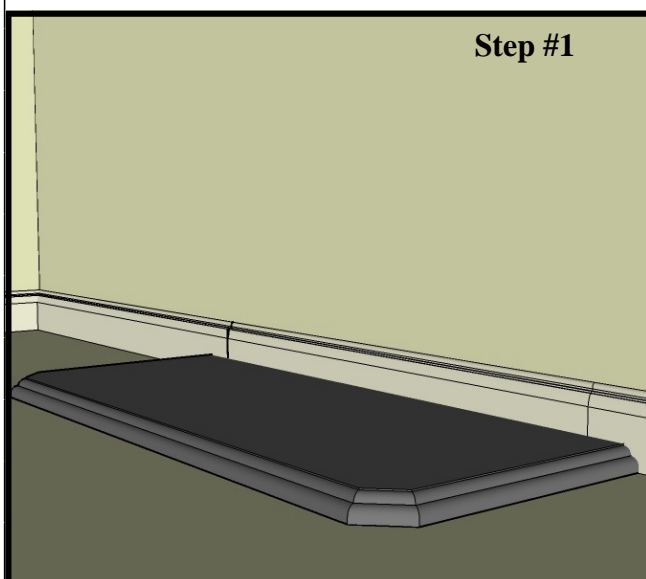

Step #1

If there is a baseboard, carefully set the hearth into position and mark the baseboard where it must be cut. Make sure that the hearth is centered to the centre mark on the wall.

Assemble the mantel [see below], and set it carefully into place centered on the hearth. Mark the baseboard where the outside foot of the mantel on each side stops. Cut the baseboard accordingly. Alternatively, the baseboard can be removed and trimmed to fit the hearth and mantel once they are fully installed.

Use a fast set adhesive such as Kerakwik M to secure the hearth to the floor. Spread the adhesive across the bottom of the hearth where it comes in contact with the floor. Pick up the hearth on edge and lay the back edge against the wall. Slowly lower the leading edge and work the hearth back and forth to insure good adhesion. Wipe off excess adhesive with a damp cloth.

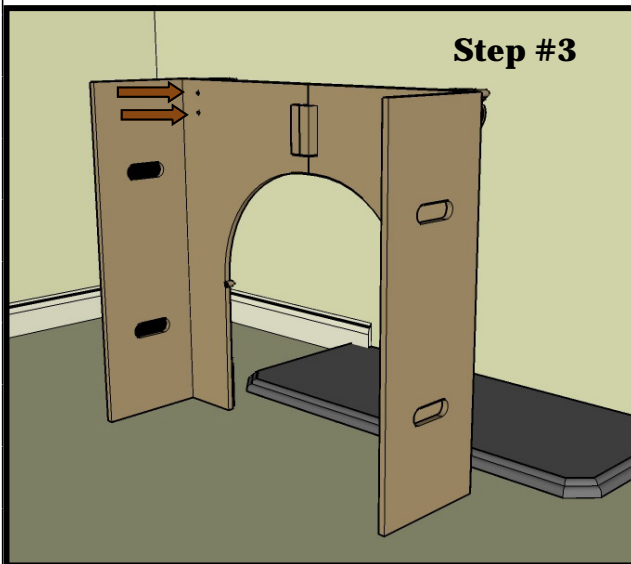
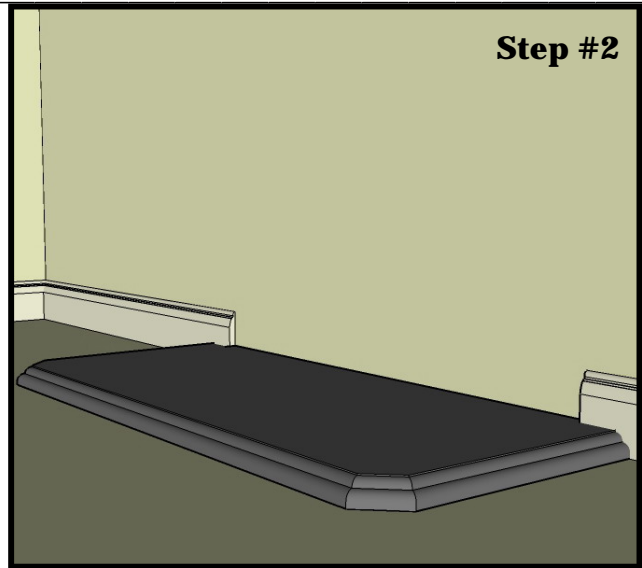

The two halves of the mantel can be connected together by inserting the bolts, washers, lock washers and nuts into the two wood cleats in the center of the back of the mantel.

Install the corbels on the legs by inserting the bolt, washer and lock nut into the upper hole in the back of the mantel leg. Also install the screw in the lower hole which locks the corbel into position.

The quoin can now be centrally positioned, and secured from behind with the 4 screws provided. Make sure that the screws are the correct length and do not protrude through the face of the quoin.

Screw the two key holed 'L' brackets to each side of the inside return of the leg, near the top. Make sure that the keyhole is located 'upside down'. Install the 4 cast grills into the cutouts in the side of the mantel.



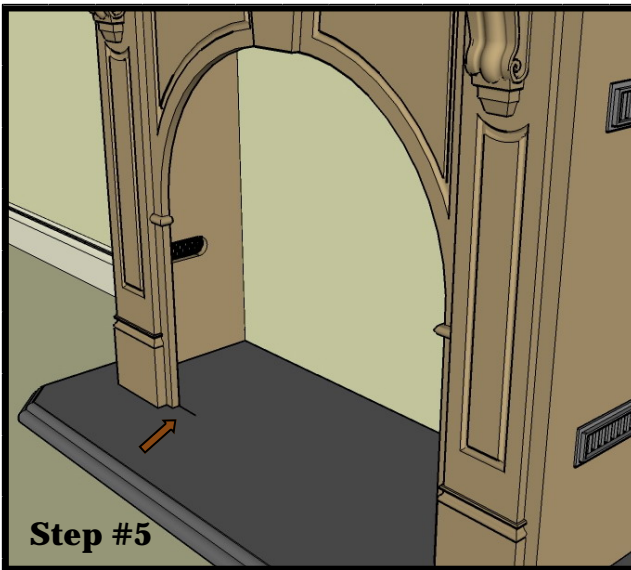

Place the mantel into final position on the wall, and mark the center of the top of the keyhole circle in the keyhole on each leg. Remove the mantel, and install the drywall plug centered on the mark you have just made. Set the screw into the wall plug so that the head is sticking out approximately 1/8" beyond the plug face. Reset the mantel into position, setting the screw head into the keyhole, and carefully allow the mantel to slid down into position.

Set the mantel onto the hearth, and make a mark at the back of the inside opening of the mantel. Remove the mantel to the side. The 530 engine can now be installed, using this mark as the main reference point. Do a dry assembly of the Windsor front onto the 530 firebox, and set the front flat section of the Windsor plate on this line. It is this line that will determine the proper location of the firebox relative to the wall.

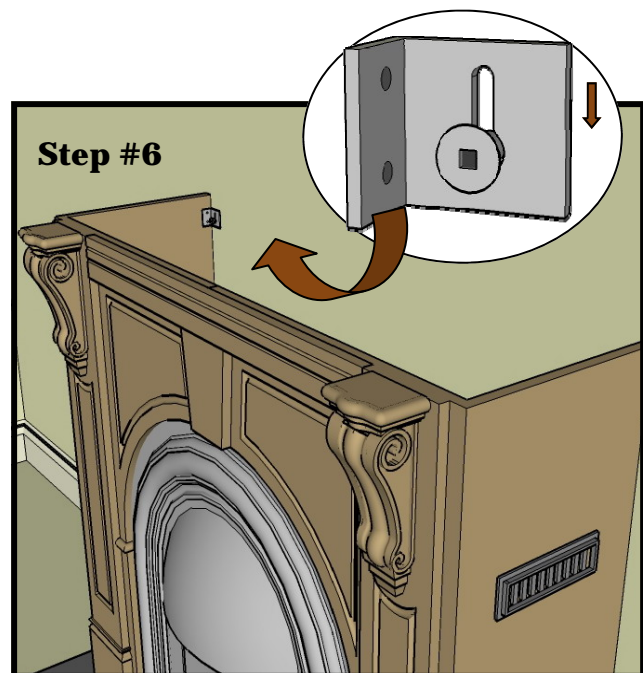

You may have to adjust the screw head in the wall plug to insure the mantel has a snug fit against the wall.

The shelf can now be slid into position, by carefully aligning it with the wooden side cleats, and gently pushing it backwards.

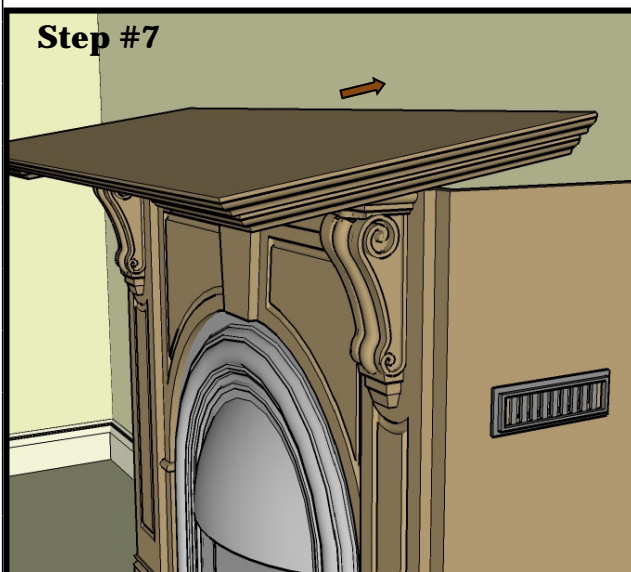

### **Barrington Cabinet**

- 1 pc left leg
- 1 pc right leg
- 1 pc shelf

**Note-** Although the Barrington cabinet can be installed with the 534 engine and the Clearview front, you cannot use the wood slip kits with this combination. You must use the Jurastone slips with the Clearview front.



## **Locating the firebox in relationship to the mantel**

It is prudent to assemble some of the pcs as a dry run before you begin to install the system, to insure that you understand how all parts fit together. This is also an excellent time to check the relationship of these pcs to the firebox itself, to insure that it is installed at the correct height, and is in the correct position relative to the wall.

Carefully lay out the boxes in an area of the room where they will be out of the way, and open them up. Remove any loose packing, and with care, pull the pieces out and lay them down on the floor where they can individually be accessed.

At all times store, carry and move the hearth on edge, to avoid cracking in the middle. The hearth must be set directly on the floor. If there is a carpet, mark the perimeter of the hearth on the carpet and cut the carpet accordingly.

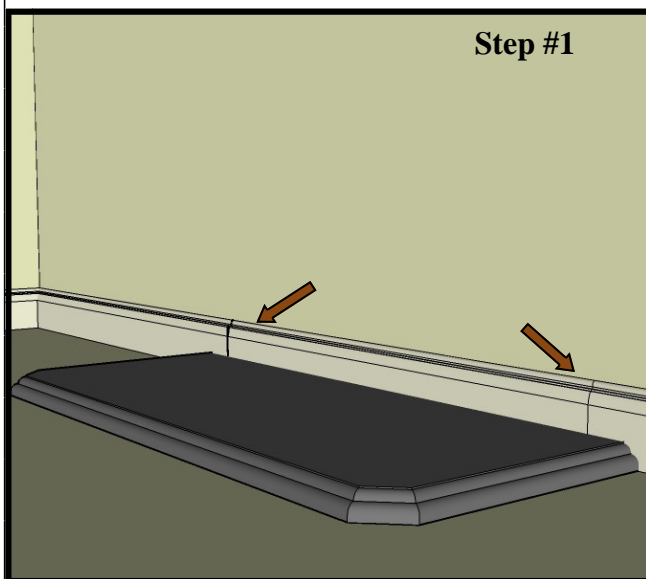

If there is a baseboard, carefully set the hearth into position and mark the base board where it must be cut. Make sure that the hearth is centered to the centre mark on the wall.

Assemble the mantel [see below], and set it carefully into place centered on the hearth. Mark the baseboard where the outside foot of the mantel on each side stops. Cut the baseboard accordingly. Alternatively, the baseboard can be removed and trimmed to fit the hearth and mantel once they are fully installed.



**Step #2**

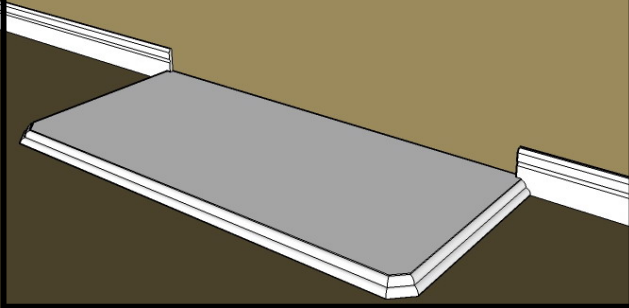

Use a fast set adhesive such as Kerakwik M to secure the hearth to the floor. Spread the adhesive across the bottom of the hearth where it comes in contact with the floor. Pick up the hearth on edge and lay the back edge against the wall. Slowly lower the leading edge and work the hearth back and forth to insure good adhesion. Wipe off excess adhesive with a damp cloth.

The best way to locate the final position of the 534 firebox [cannot be installed with a 535 firebox!] is to use a leg and one of the side slips. By carefully setting the firebox centered onto the hearth, you can fit one of the legs into position and bring the firebox forwards so that it touches the back of the slip face, which should be set against the back of the opening edge of the leg. Make sure that you use a leg and a sip piece, if installing the 534 firebox! Make a small pencil mark on the hearth indicating the final resting position.

**Step #3**

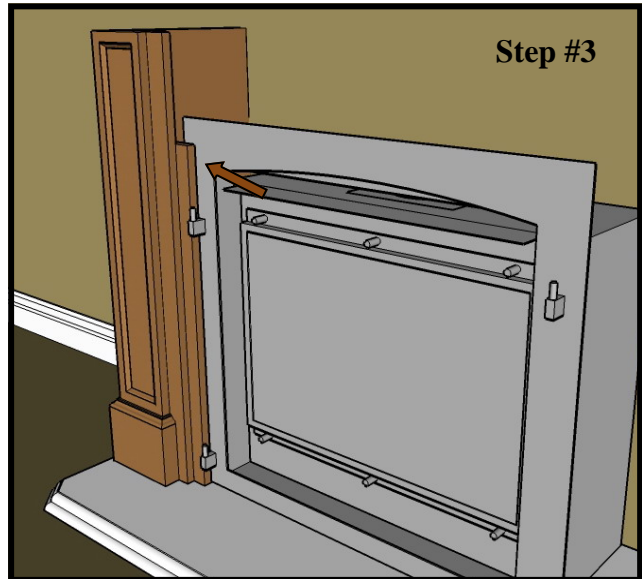

**Step #4**

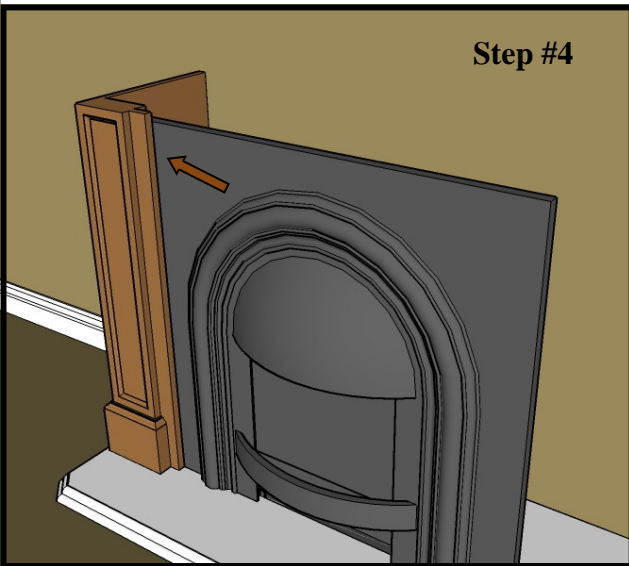

If installing the Barrington with one of the 530 and one of the backpanels, then you should again use the leg to locate the final resting point for the firebox and backpanel. Fit the C channels to the sides of the firebox [as shown on page 3], dry fit the backpanel to the firebox, and center this on the hearth. Carefully bring this to the back of the opening edge of the leg, and make a small pencil mark on the hearth indicating the final resting position.

To assemble the mantel, carefully position the two legs, and set the shelf down on top of the legs. Use the bolts, washers and nuts to firmly attach these parts together.

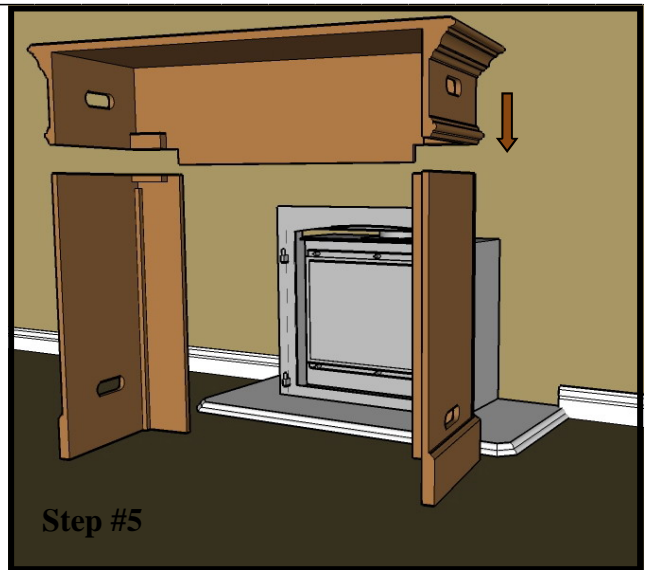
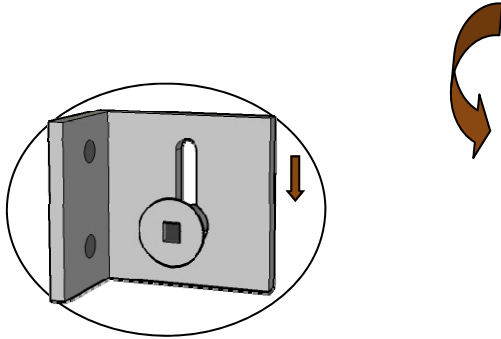

Step #5

When installing the Barrington with the Fenderfire front, then you will need to install the wood slips onto the back of the opening of the mantel. Position a side slip so that there is 1 3/8" exposed on the front.

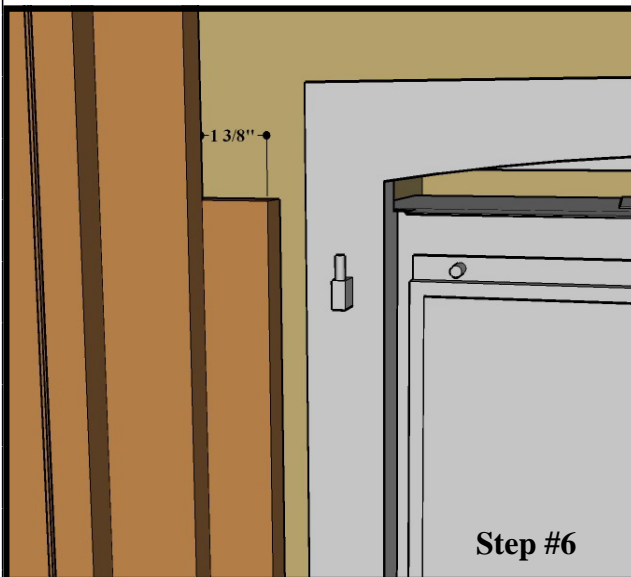

Step #6

After checking that the 'reveal' of the slip is consistent from top to bottom, secure it with three screws into the back of the mantel leg. Make sure that the screws used are short enough to prevent their poking through the front of the mantel leg.

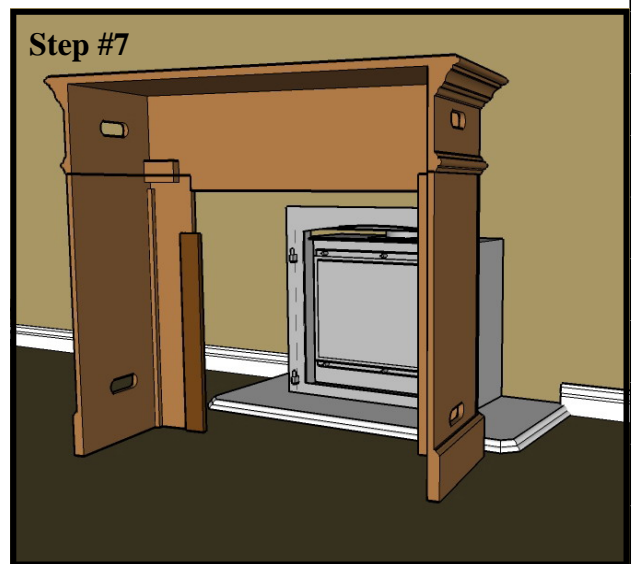

Step #7

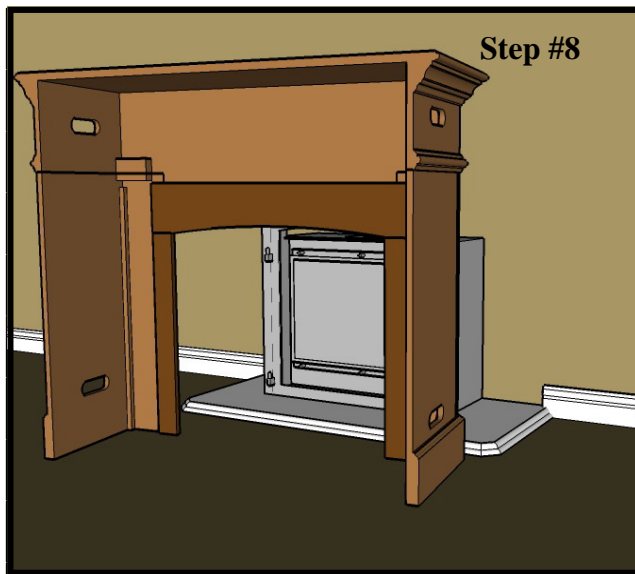

Once the two side slips are properly positioned and secured, you can now install the top slip.

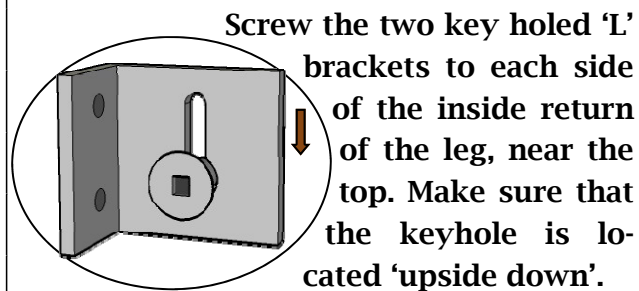

Once you have the brackets installed, you will need to dry fit the mantel onto the wall around the firebox. Measure how far down the from the shelf the top of the key hole slot is located, and how far in from the outer edge of the mantel.

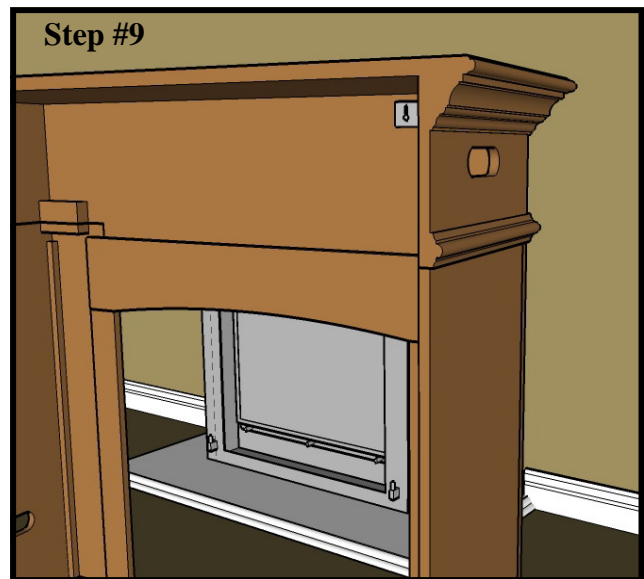

Check the fit and positioning of the mantel. Install the 4 cast grates into the holes on the sides of the mantel with the screws provided.

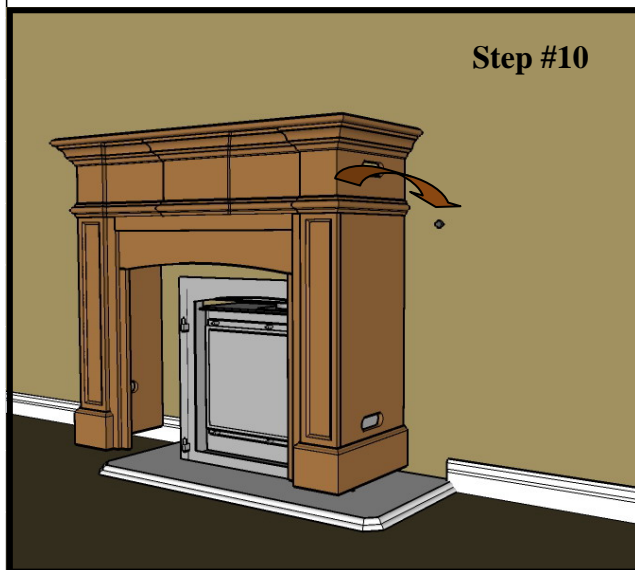

## **Care and Maintenance of Your Suite.**

The mantels may need to be polished with a good furniture polish from time to time.

The castings are painted then polished to give the highlighted effect. Water splashed on the casting will cause rust and should be wiped off immediately. If rust does appear, wiping the affected area with a cloth sprayed with WD40 is sufficient to remove the rust. In stubborn situations, the cast area may have to be lightly buffed or rubbed with a very fine grit emery cloth.

**Distributed by**



**137 Nelson St**

**Brantford Ont N3S 4B5**

**1 800 325 7988**

**[info@firesoftradition.com](mailto:info@firesoftradition.com)**